

tool list

Pos.	pieces	prefix	ID number	Ver.	ZKZ	BL	spindle profile part	short-cut	profile name / comments	tool description / tool system	cutting material	number of teeth	zero Ø
tools for frame profiles IV93 (all systems)													
1	1	L	954 000	711003	SA	01			frame tenon to head	ProfilCut Q set	MC	2	320
2	1	L	954 001		SA	04			frame tenon to sill	Tumblade tool	MC	2	320
3	1	L	954 002	711003	SA	01			frame slot	Tumblade set	MC	2	320
41	1	L	954 003	711001	SA	01			frame inner profile of head & jambs	ProfilCut Q set	MC	2	140
5	1	L	954 004		SA	SA02			frame inner profile of sill	Tumblade tool	MC	2	140
tools for sash profiles IV57 - tenon / slot / inner (all systems)													
6	1	L	954 007	711003	SA	01			sash tenon on top and bottom part	Tumblade set	MC	2	320
7	1	L	954 008	711003	SA	01			sash slot to stiles	ProfilCut Q set	MC	2	320
42	1	L	954 009	711001	SA	01			sash inner profile	ProfilCut Q set	MC	2	140
tools for sash outer profiles IV57 (Lignum Flush casement)													
43	1	L	954 010	711001	SA	01			sash outer profile of stiles and top rail	ProfilCut Q set	MC	2	140
44	1	L	954 011	711001	SA	01			sash outer profile bottom rail	ProfilCut Q set	MC	2	140
45	1	L	954 012	711001	SA	01			sash outer profile of stiles	ProfilCut Q set	MC	2	140
tools for sash outer profiles IV57 (box sash)													
46	1	L	954 013	711001	SA	01			sash outer profile top rail	ProfilCut Q set	MC	2	140
47	1	L	954 014	711001	SA	01			sash outer profile of stiles	ProfilCut Q set	MC	2	140
1	1	L	170 179 676		SA	01			sash outer profile bottom rail	ProfilCut Q set	MC	2	140
tools for sash outer profiles IV57 (doors)													
36	1	L	954 016	711001	SA	01			sash outer profile of stiles and top rail	ProfilCut Q set	MC	2	140
37	1	L	954 018	711001	SA	01			sash outer profile right side for french doors	ProfilCut Q set	MC	2	140
38	1	L	954 019	711001	SA	01			sash outer profile left side for french doors	ProfilCut Q set	MC	2	140
alternate knives													
18	2	L	414 061						alternate knife for "Bevel"	according to drawing 954000/711003			
19	2	L	414 063						alternate knife for "Lamb's Tongue"	according to drawing 954000/711003			
20	2	L	414 894						alternate knife for "Bevel"	according to drawing 954003/711003			
21	2	L	414 892						alternate knife for "Lamb's Tongue"	according to drawing 954003/711003			

tool list

Pos.	pieces	prefix	ID number	Var.	ZKZ	BL	inside profile part	short-cut	profile name / comments	tool description / tool system	cutting material	number of teeth	zero ID
additional tools													
22	1	L	170 179 671		SA	01			stormproof sash outer profile	ProfilCut Q set	MC	2	140
23	1	L	11 000 000	702634					spacer 90x20.5x60				
24	1	L	170 179 672		SA	01			sash tenon on top and bottom part	ProfilCut Q set	MC	2	320
25	1	L	170 179 673		SA	01			sash inner profile	ProfilCut Q set	MC	2	140
26	1	L	170 179 674		SA	01			frame cill groove	ProfilCut Q set	MC	2	140
39	1	L	954 032	711004	SA	01			horn profile 3	ProfilCut Q set	MC	2	125
28	1	L	82 308						customer folder				

IV57/93 Lignum Flush casement

vertical section

squared version (cill & sash bottom rail)

edge connection

lot & tenon



all beads are offline

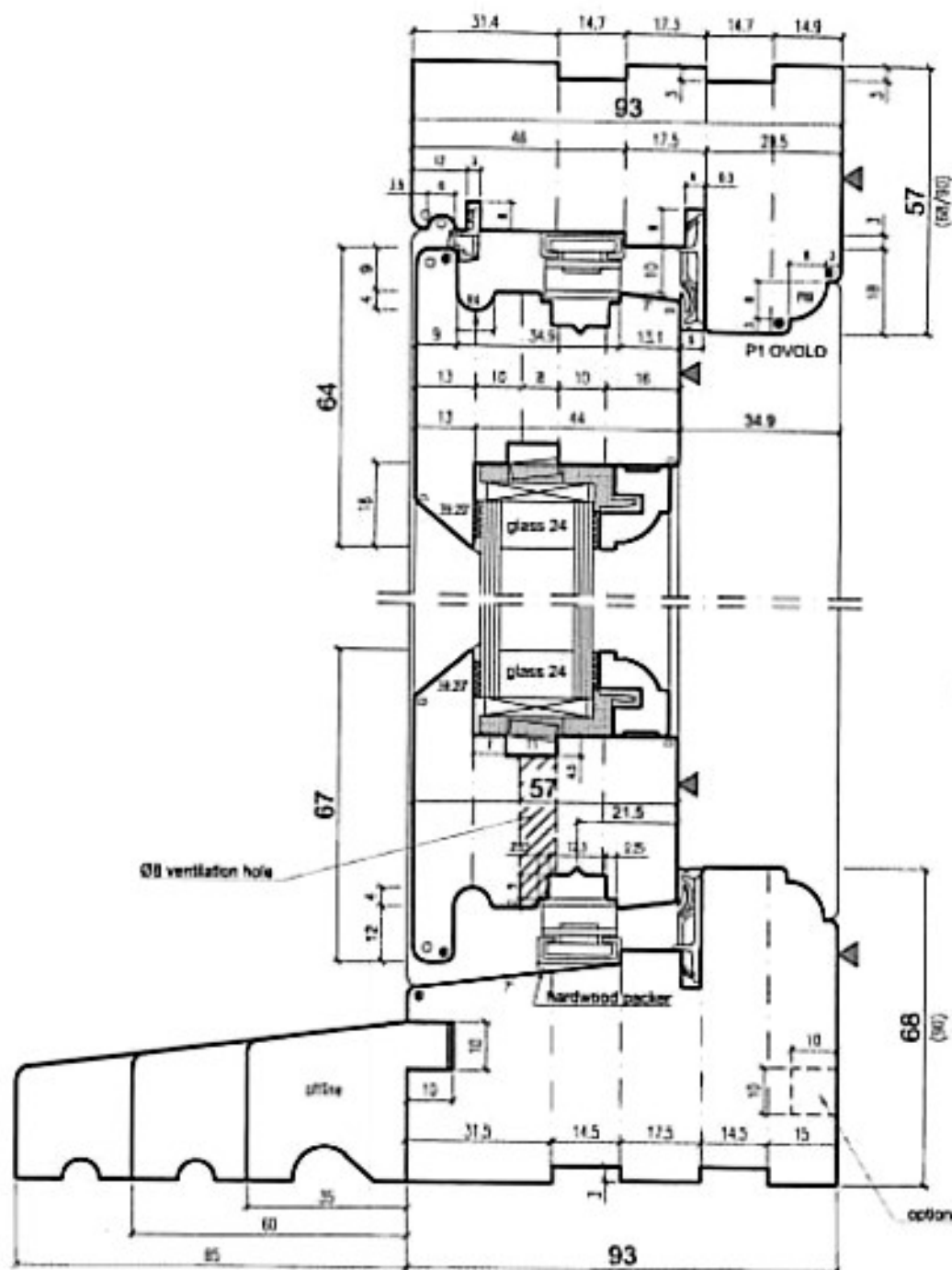

Profile options for frame:

P2 OVOLD closed joint

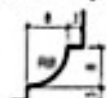

P3 Lambé Tongue

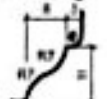

P4 Lambé Tongue closed joint



P5 Bevel



P8 squared



optional window board groove

R 1.0
 R 1.5
 R 2.0
 R 3.0

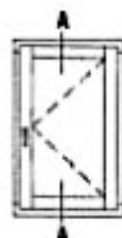

IV57/93 Lignum Flush casement

horizontal section



edge connection
lot & tenon

all beads are offline

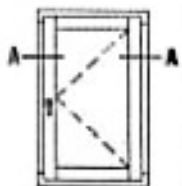
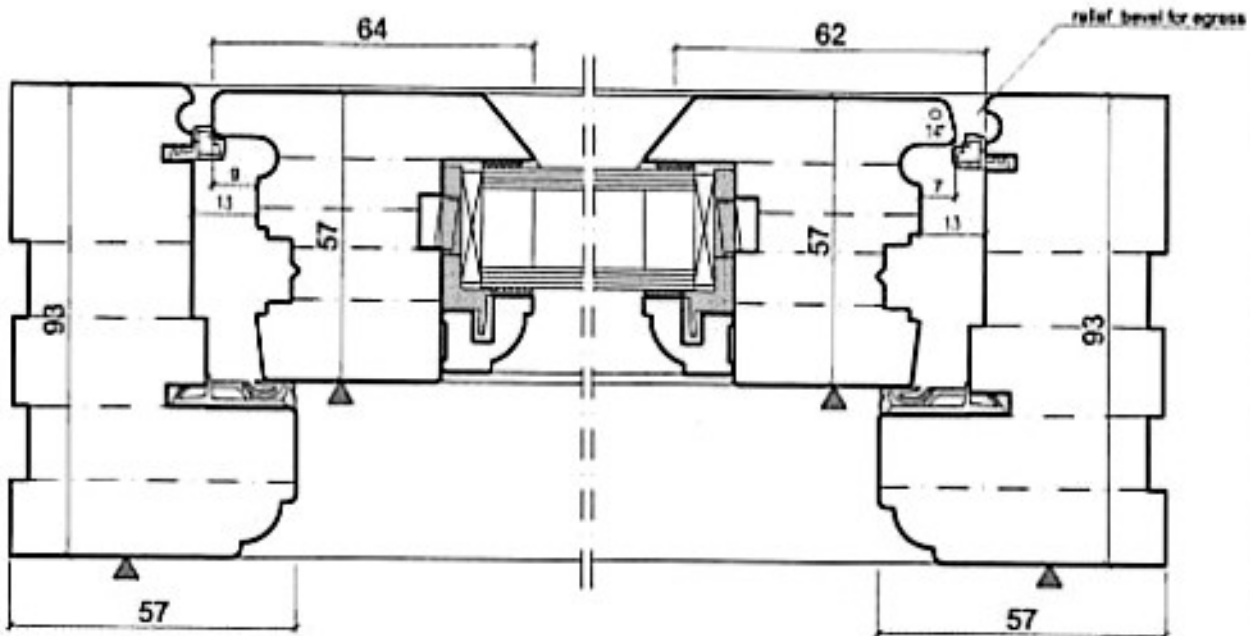
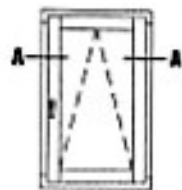
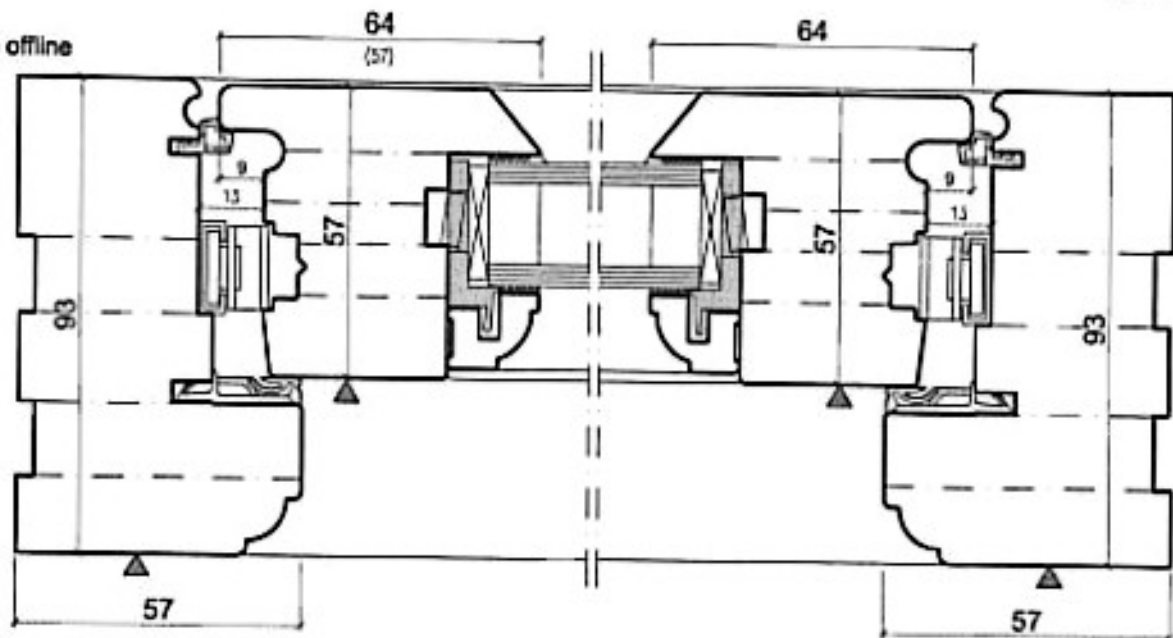

- 1.0
- 1.5
- R 2.0
- R 3.0

IV57/93 Lignum Flush casement

double sash window with mullion/transom
edge connection
lot & tenon

leitz
Schnitt & Erdbeurteil

all beads are offline

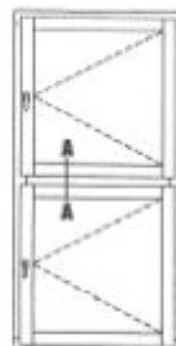
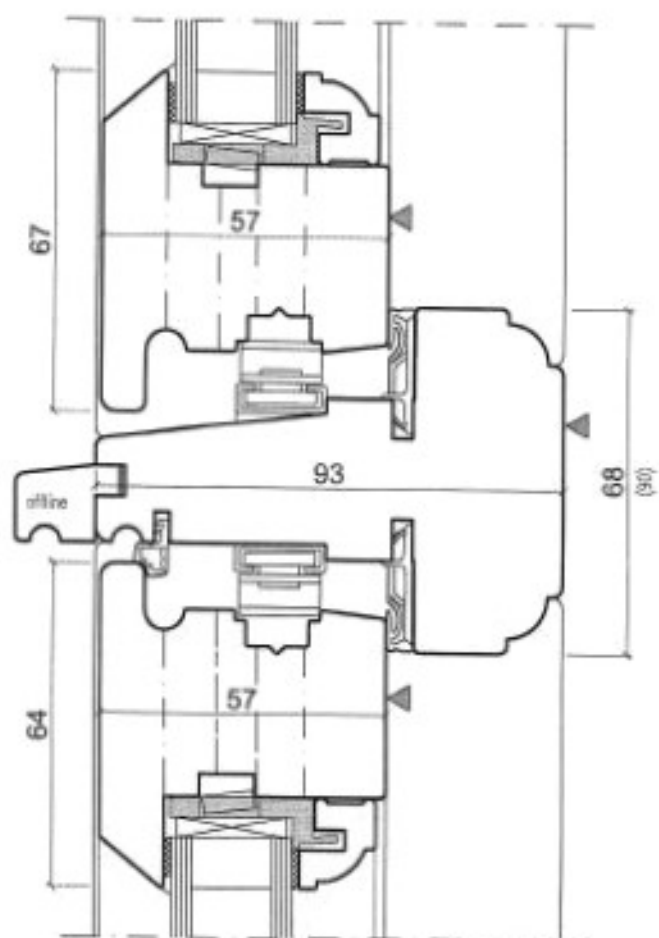
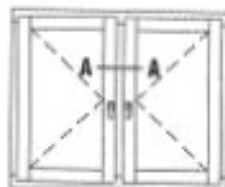
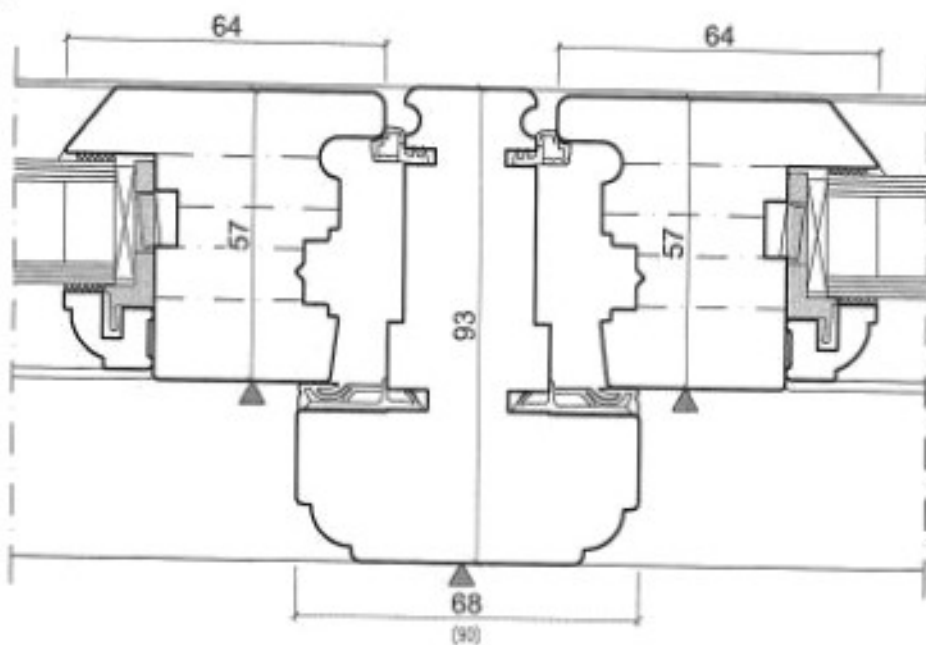

● R 1.0
● R 1.5
● R 2.0
○ R 3.0

gez. u. gepr. 17.12.2020 LDA
Schutzmerk ISO 10016 beachten

L 92777

PZ03

IV57 Lignum box sash window

horizontal section

sash edge connection
lot & tenon

all beads and frame boards
are produced offline!

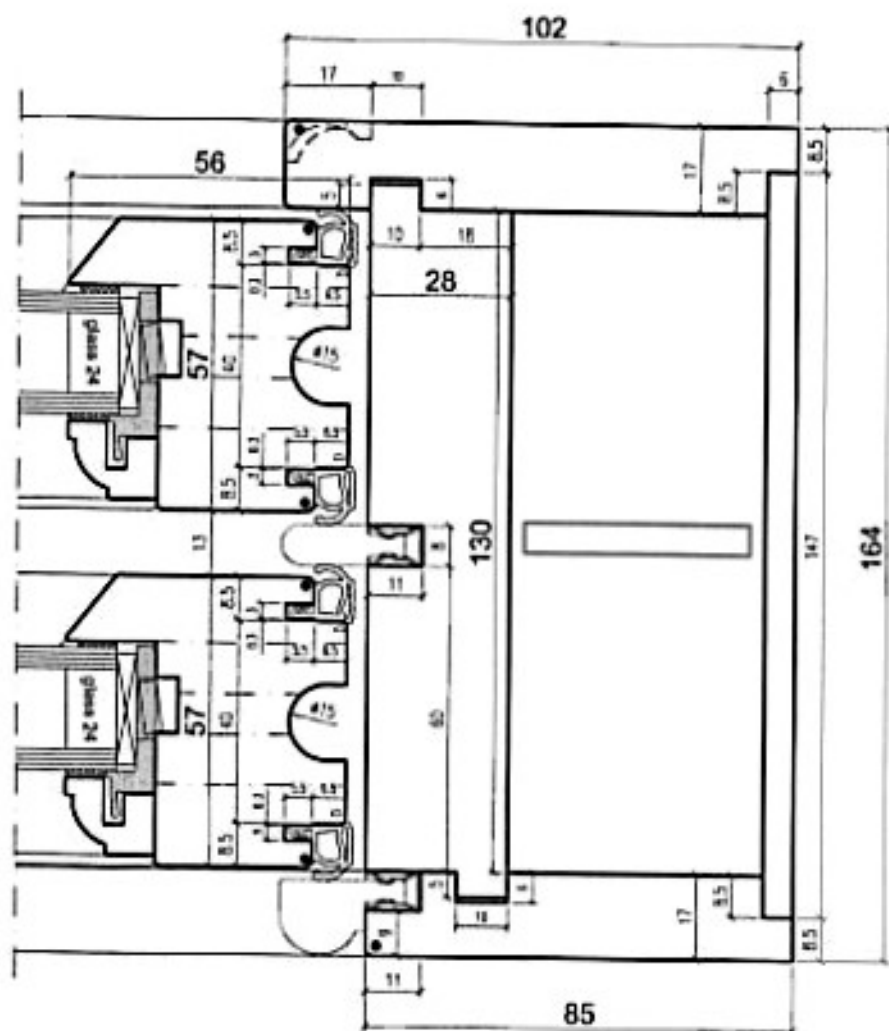

— R 1.0
 — R 1.5
 — x 2.0
 — R 3.0

gez. u. gepr. 17.12.2020 LDA
Schutzvermerk ISO 19016 beschieben

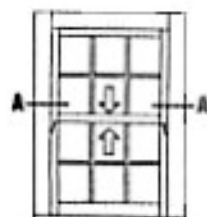

L 92778

P202

all beads and frame boards
are produced offline!

frame cill option

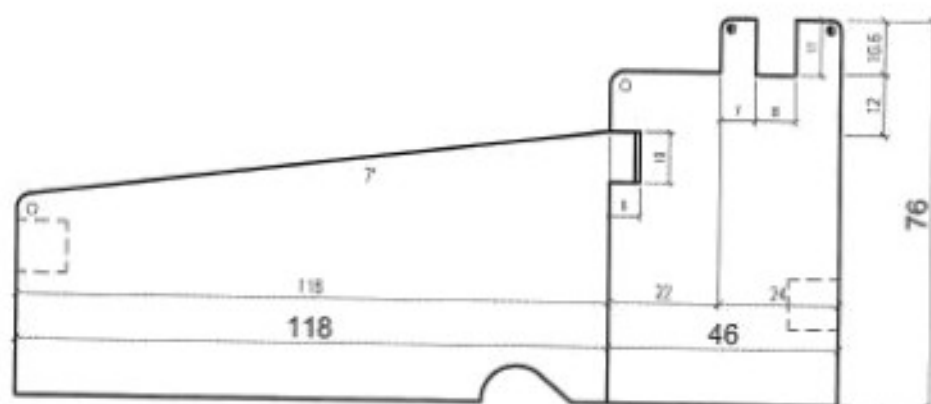

Optional Horns

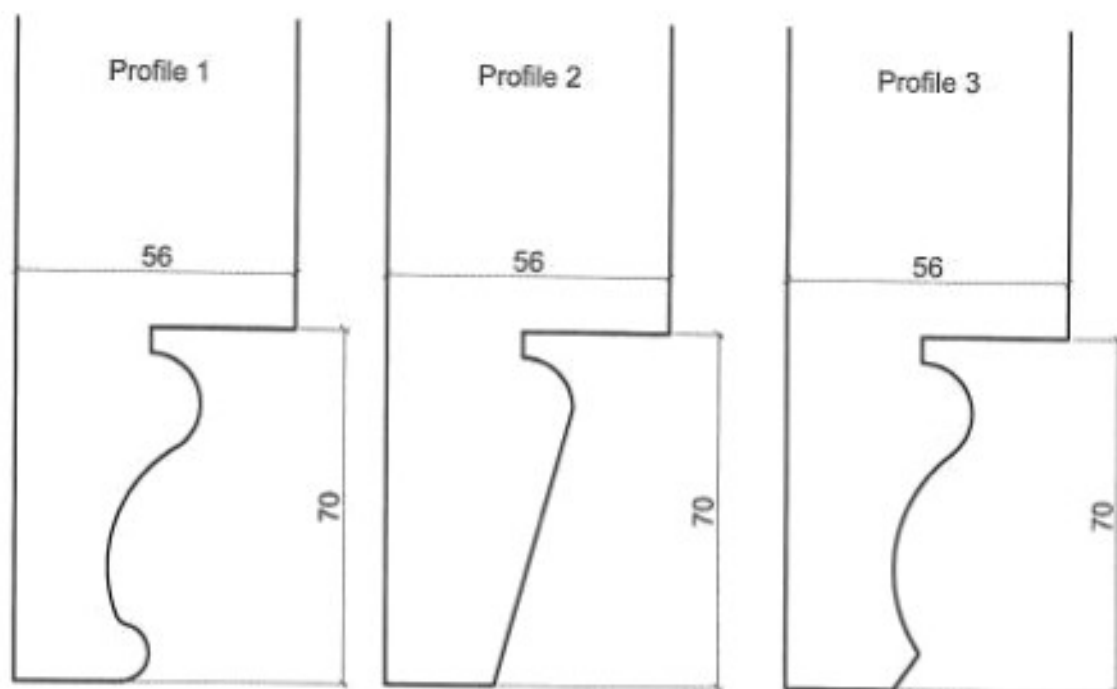

IV57/93 Lignum Flush casement door

vertical section

squared version (cill & sash bottom rail)

edge connection

lot & tenon



all beads are offline

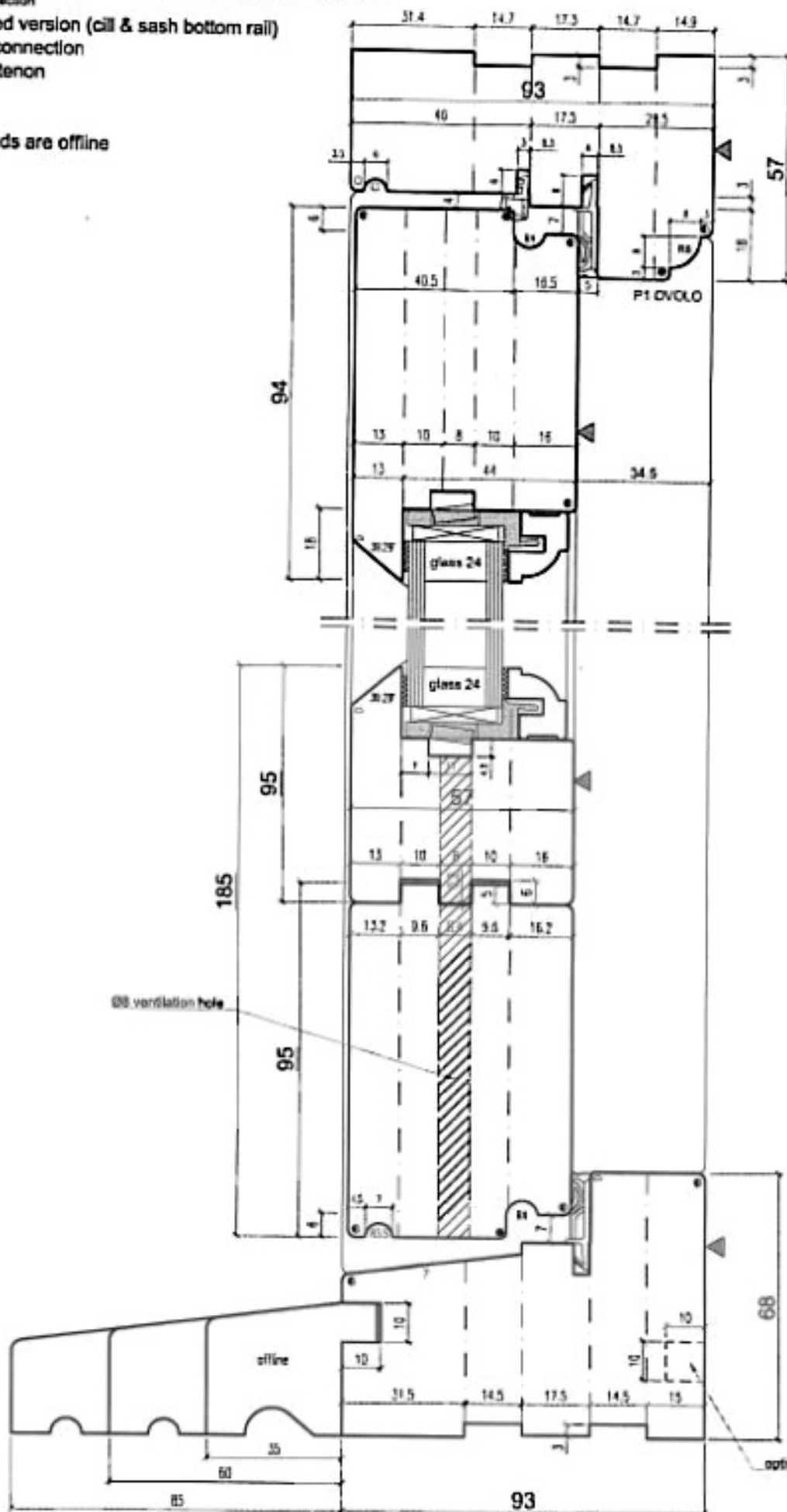

Profile options for frame:

P2 OVOLO closed joint

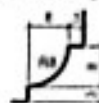

P3 Lamba Tongue

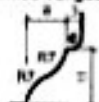

P4 Lamba Tongue closed joint

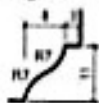

P5 Bevel

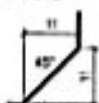

P6 squared



- ⌀ R 1.0
- 1.5
- 2.0
- ⌀ R 3.0

IV57/9' **ignum** Flush casement door
horizontal section

edge connection
slot & tenon

all beads are offline

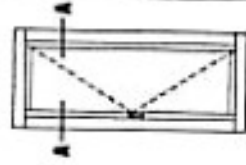
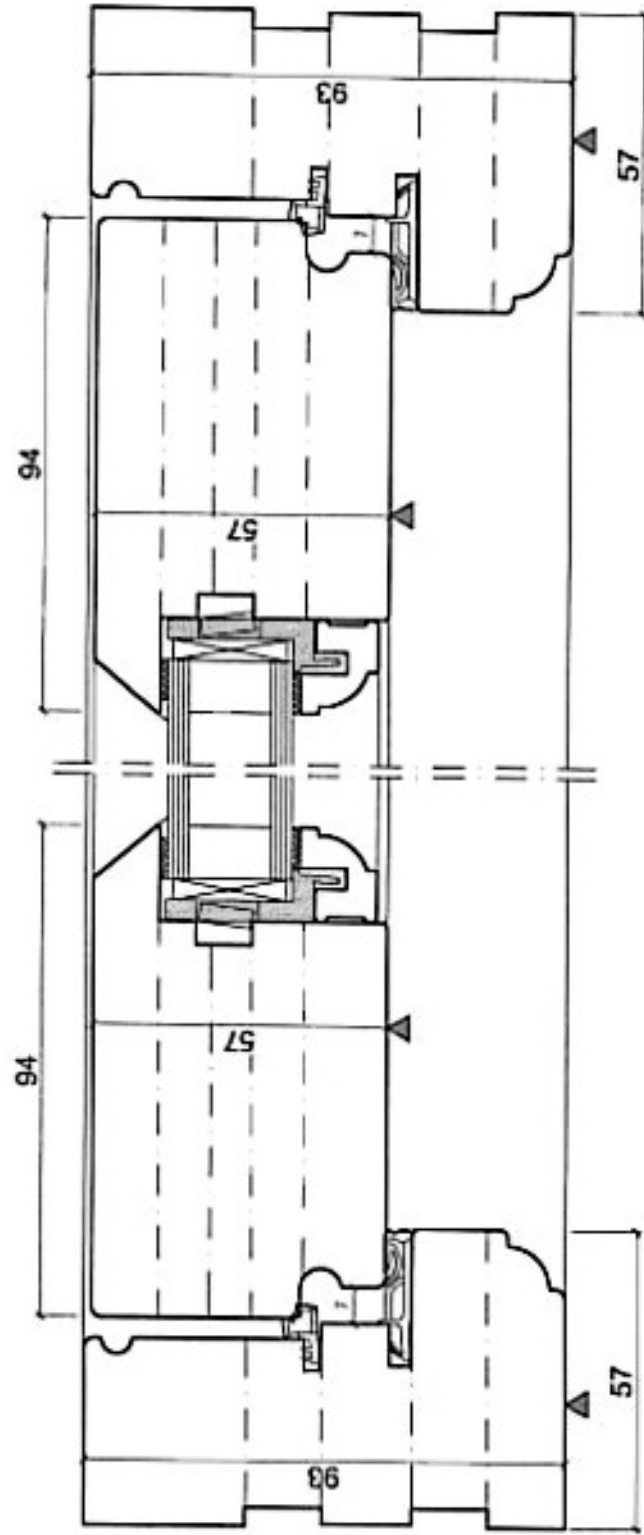

- R 1.0
- R 1.5
- R 2.0
- R 3.0

gez. u. gepr. 17.12.2020 LJA
Schulzemark 60 18016 Brachles

IV57/53 Lignum Flush casement door

horizontal section

edge connection
slot & tenon

all beads are offline

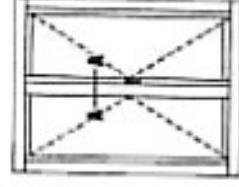
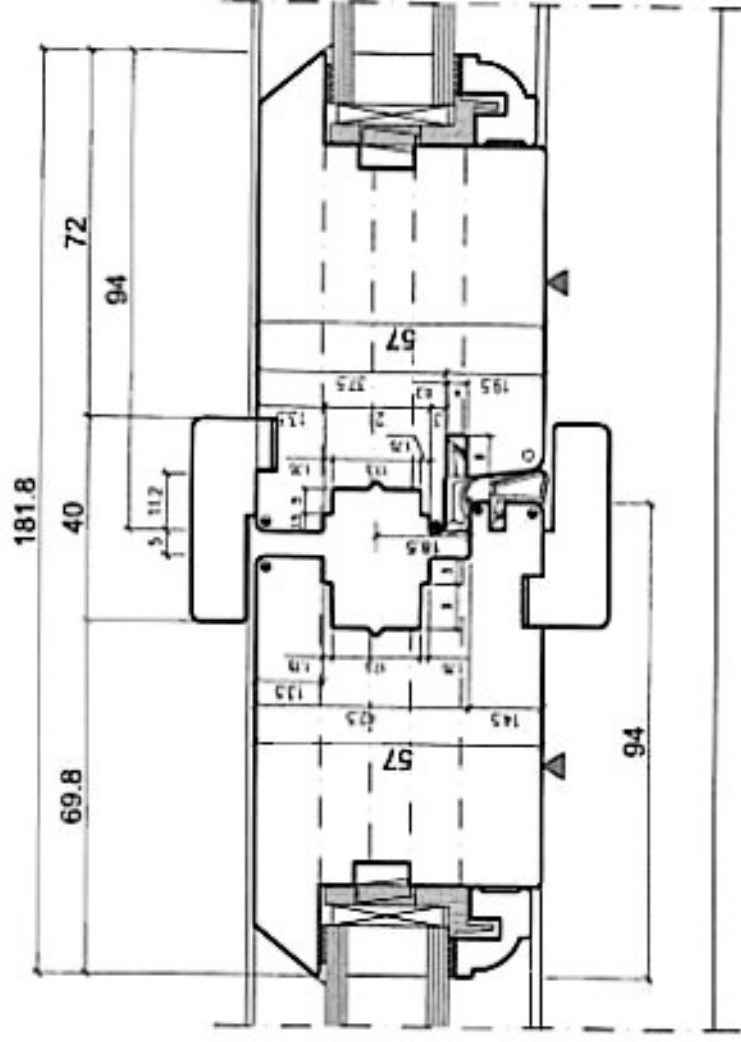

- R 1.0
- R 1.5
- R 2.0
- R 2.5

IV57/93 Lignum Flush casement door

vertical section

squared version (cill & sash bottom rail)

edge connection
of & tenon



all beads are offline

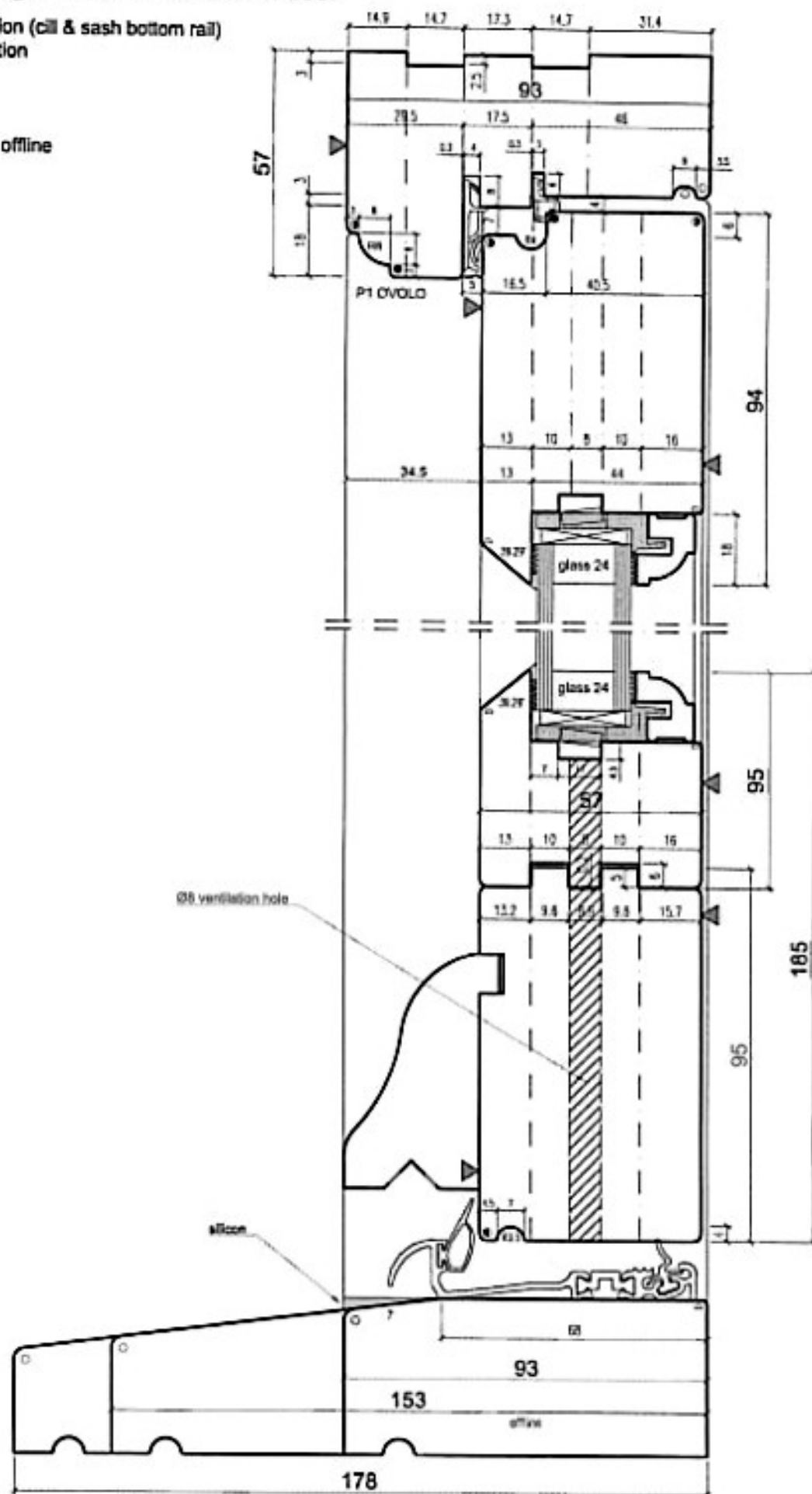

R 1.0
1.5
2.0
3.0

gez. u. gepr. 17.12.2020 LSA
Schulzmerker ISO 16016 besicht

1 Ausführung richtig gezeichnet - 21.06.2021 LSA

L 92779/1 P201

IV57/9 Jignum Flush casement door

horizontal section

edge connection
slot & tenon

all beads are offline

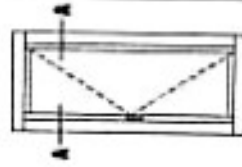
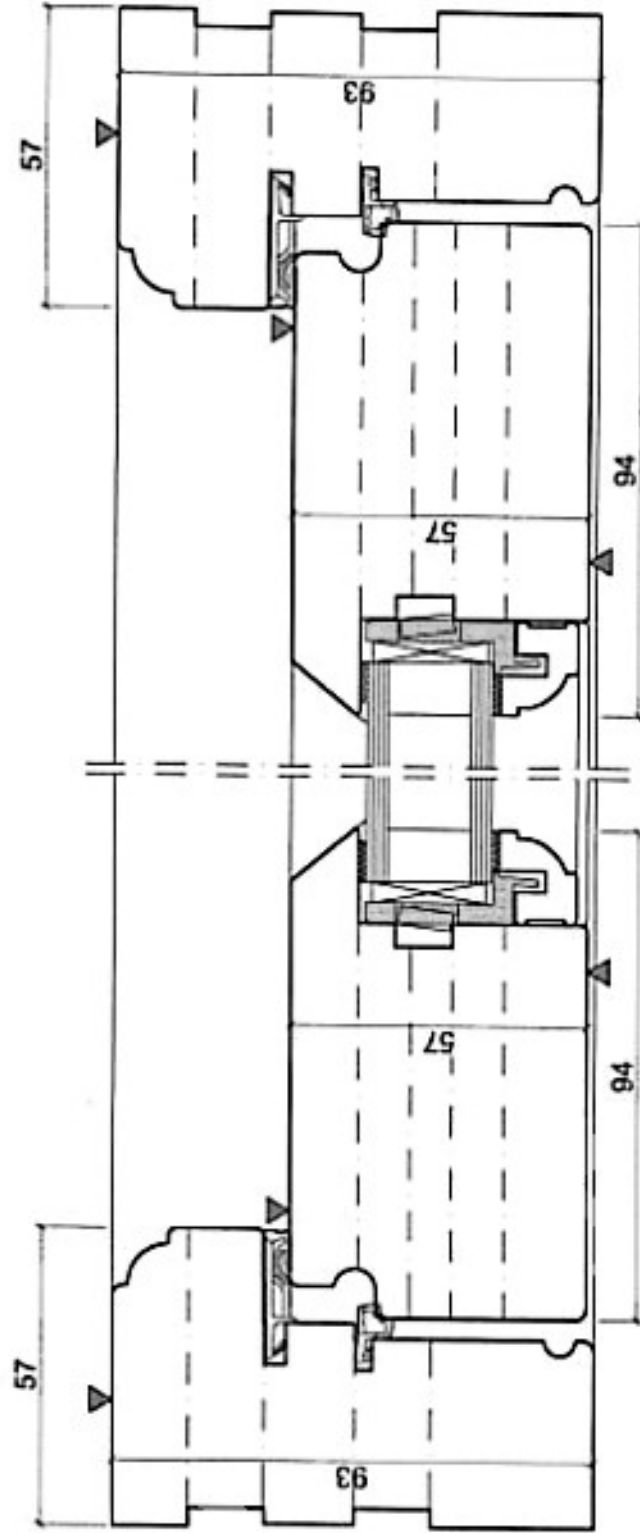

IV57/9C Agnum Flush casement door

horizontal section

edge connection
slot & tenon

all beads are offline

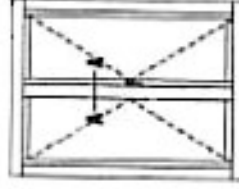
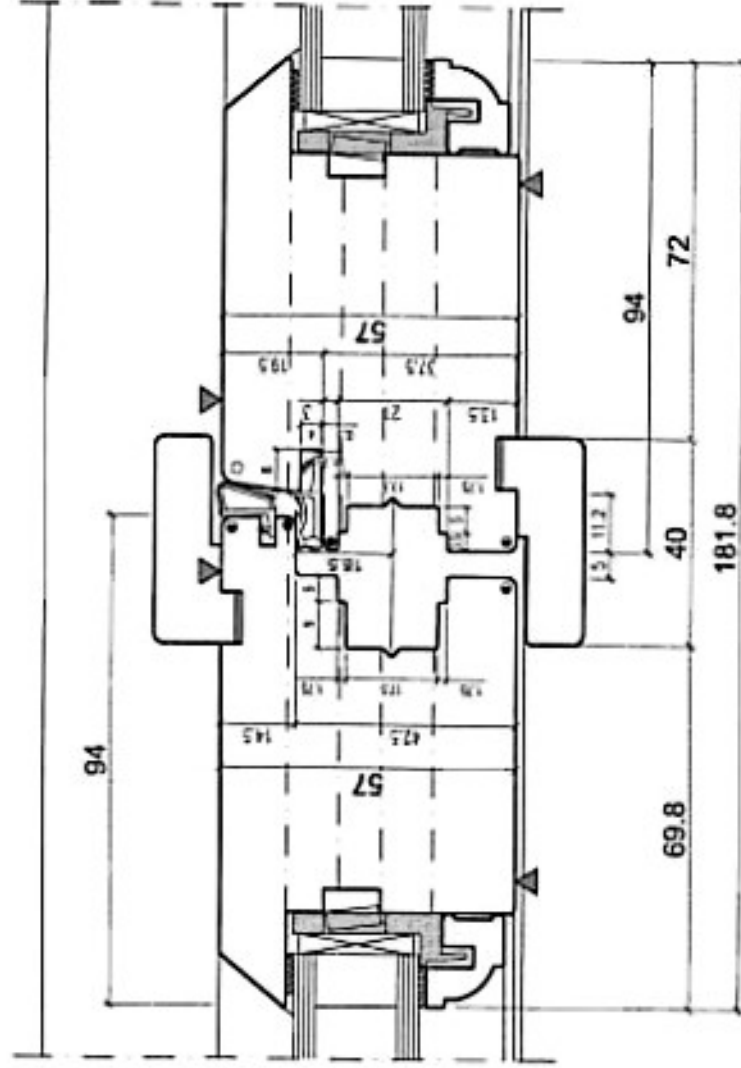

AL. No.	Description	Date	Name	est.
① 1	HM-Ringe E. Herm Dore/Lakob entfern.	18.11.202	LDA	LDA

Alternate knife available on request:

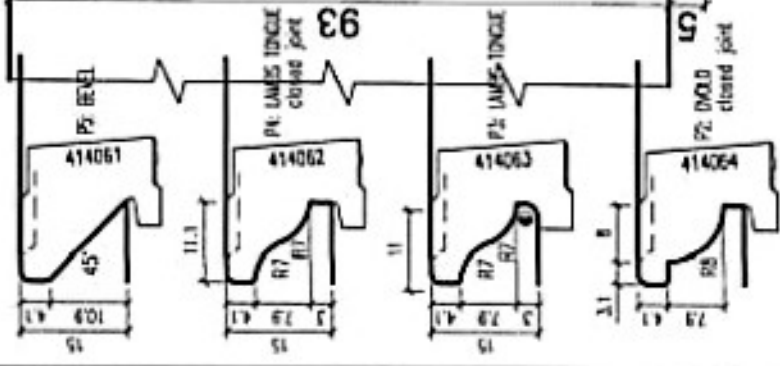

Ø320

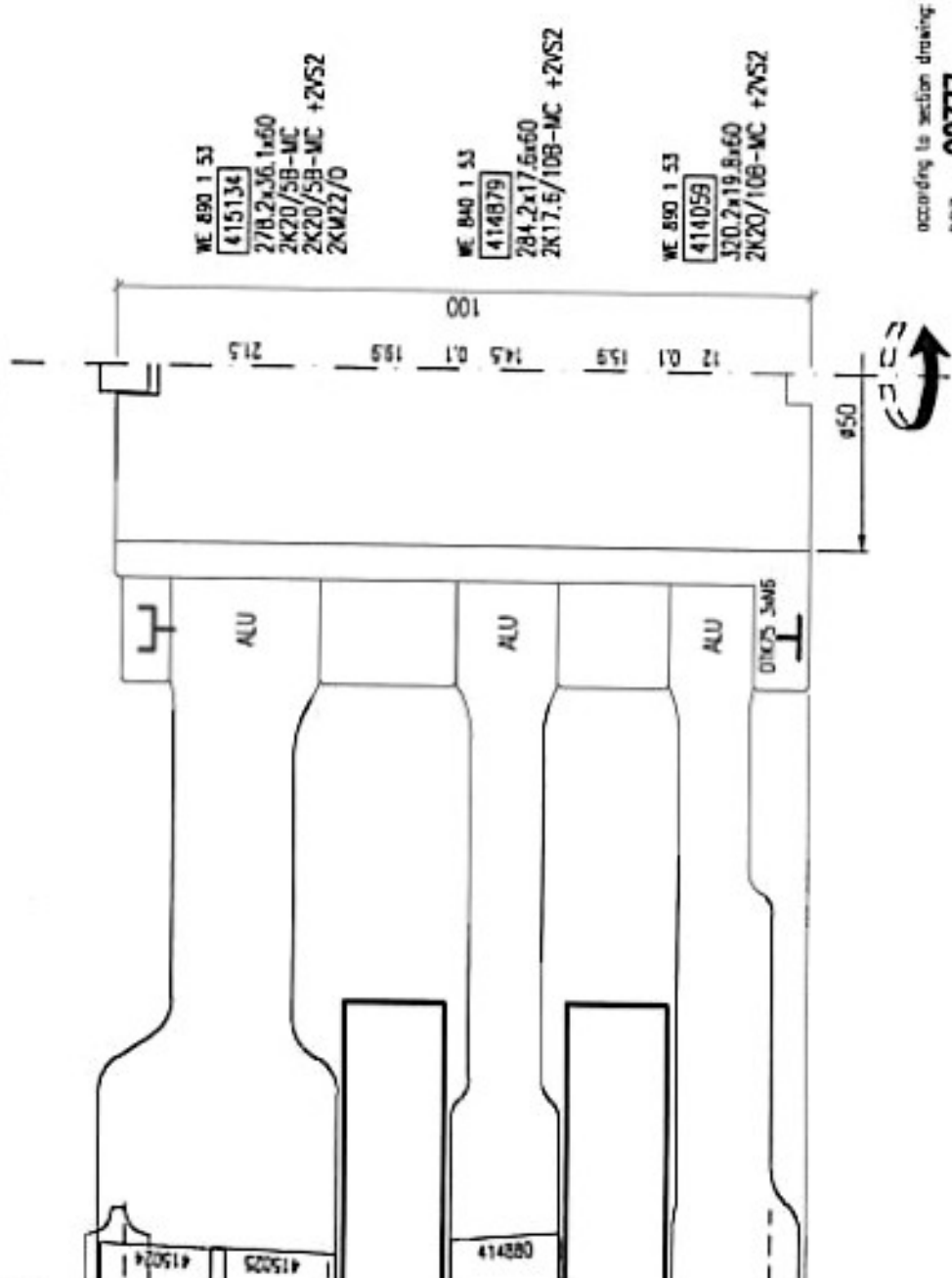

WE 890 1 53
415134
278.2x36.1x60
2K20/5B-MC
2K20/5B-MC +2V52
2K22/0

WE 840 1 53
414879
284.2x17.5x60
2K17.6/10B-MC +2V52

WE 890 1 53
414059
320.2x19.8x60
2K20/10B-MC +2V52

according to section drawing
PRZ = 92777

Z	2
Cutting Angle:	
ZSH	90
MAN (Manual Feed)	
n max./R.P.M.	5300

Refer to protection notice SO 16018	2020	Date	Name	Plant
Tolerances to LITZ Normnorm	dhw	18.12.	LDA	A-4752 BEDAU AUSTRIA
Quality MC	exc	18.12.	LDA	
Scale 1:1	dit.			

leitz	
ProfilCut Q set	
N57/93 Lignum Flush Casement frame tenon to head	

Replacement for Previous Leitz No.	SE 150 1 53	LeitzDA
Filing No.		
Article-No.		
Ident.-No.	L 954000/711003	SA01

Art. No.	Description	Date	Name	ess.
1	NM-förge z. Horn-Dorn/Jacob entfemt.	18.11.2021	LDA	LDA

Alternate knife available on request:

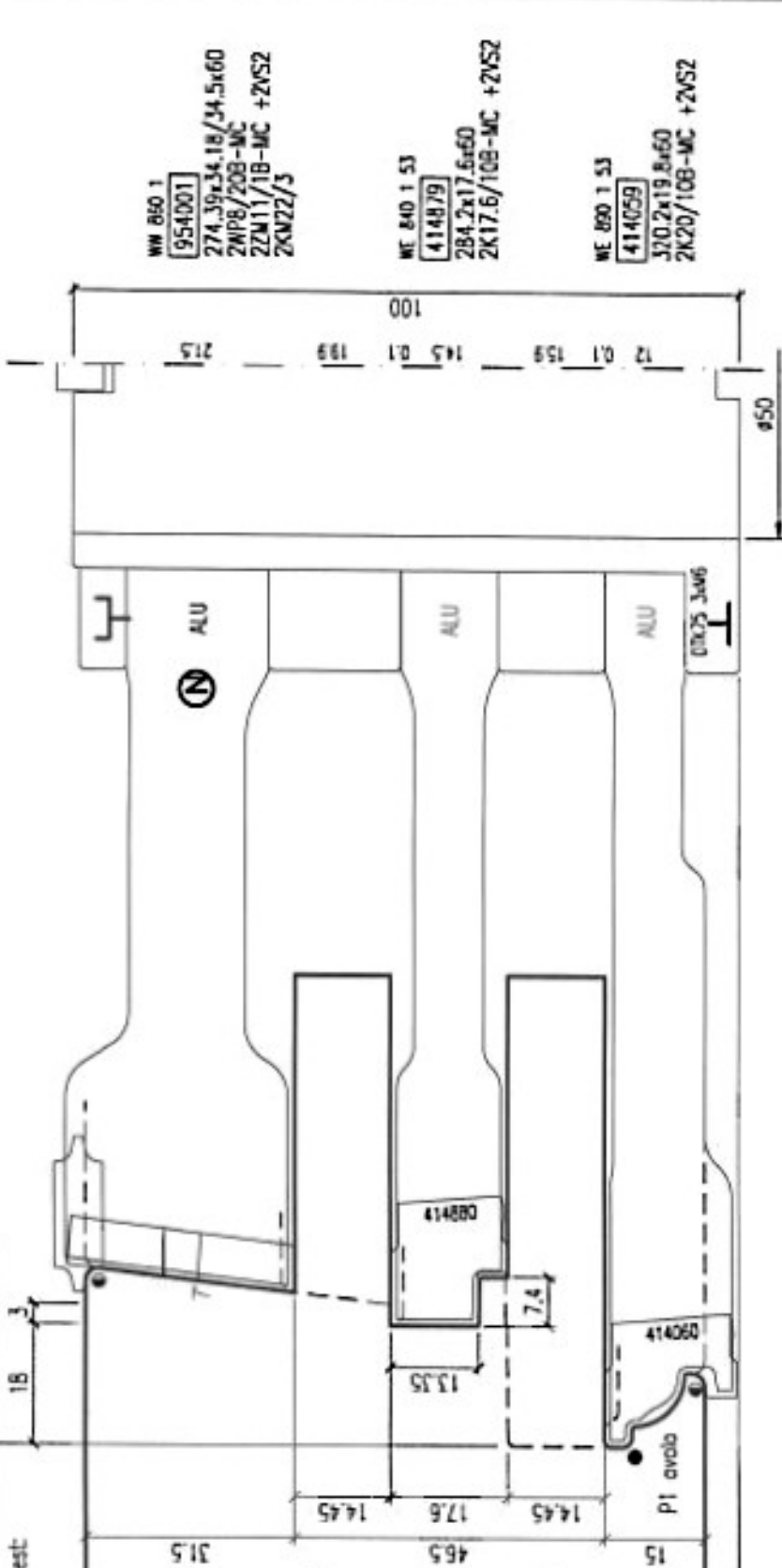
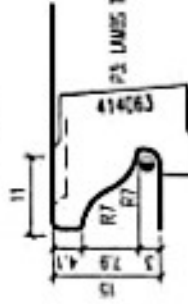
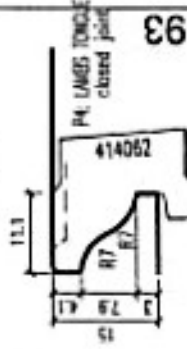
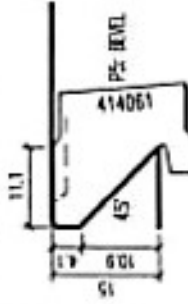

WW 860 1
954001
274.39x34.18/34.5x60
ZNP8/208-MC
ZZM11/18-MC +ZVS2
ZKN22/5

WE 840 1 S3
414879
284.2x17.6x60
2K17.6/108-MC +ZVS2

WE 890 1 S3
414059
370.2x19.8x60
2K20/108-MC +ZVS2



NEW

To be assembled with existing parts at the customer from 954000/711003

according to section drawing
PBZ = 92777

Z	2
Cutting Angle:	
Zone:	90
MAN (Manual feed)	
n max./RPM:	5300

Refer to protection notice ISO 16016	2020	Date	Name	Plant
Tolerances to LEITZ Networks	dra.	18.12.	LDA	A-4752 REZDU AUSTRIA
Quality MC	ess.	18.12.	LDA	
Scale 1:1	det.			

		turnblade bevel tenoning tool W57/93 Lignum Flush Casement from tenon to rail	
		Article-No.	WW 860 1
Replacement for Previous Leitz No. Filing No.		LeitzOO	
Ident.-No.		L 954001 SA04	

AL. No.	Description	Date	Name	ent.
1	EW-Ring B. Herm. Dorn/Lochsch. effizient.	16.11.2021	LDA	LDA

Alternate knife available on request:

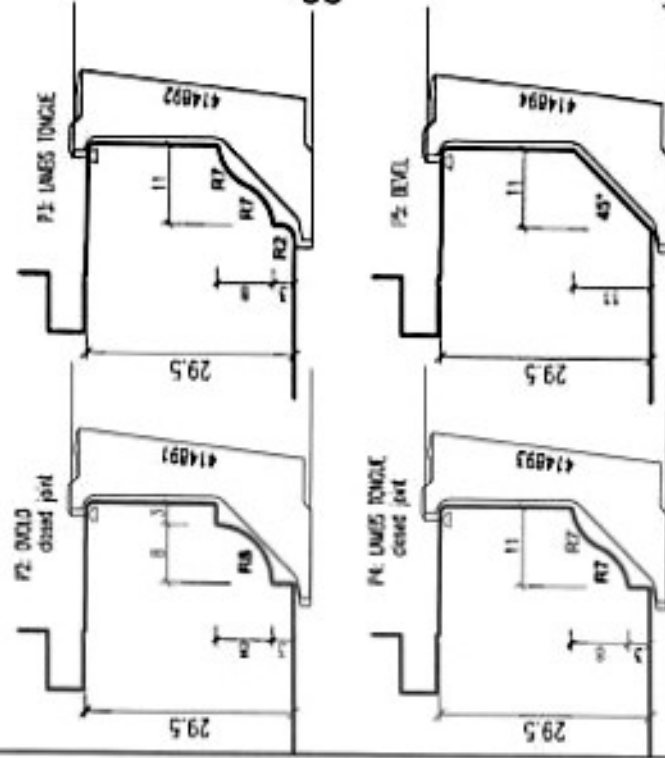

Ø140

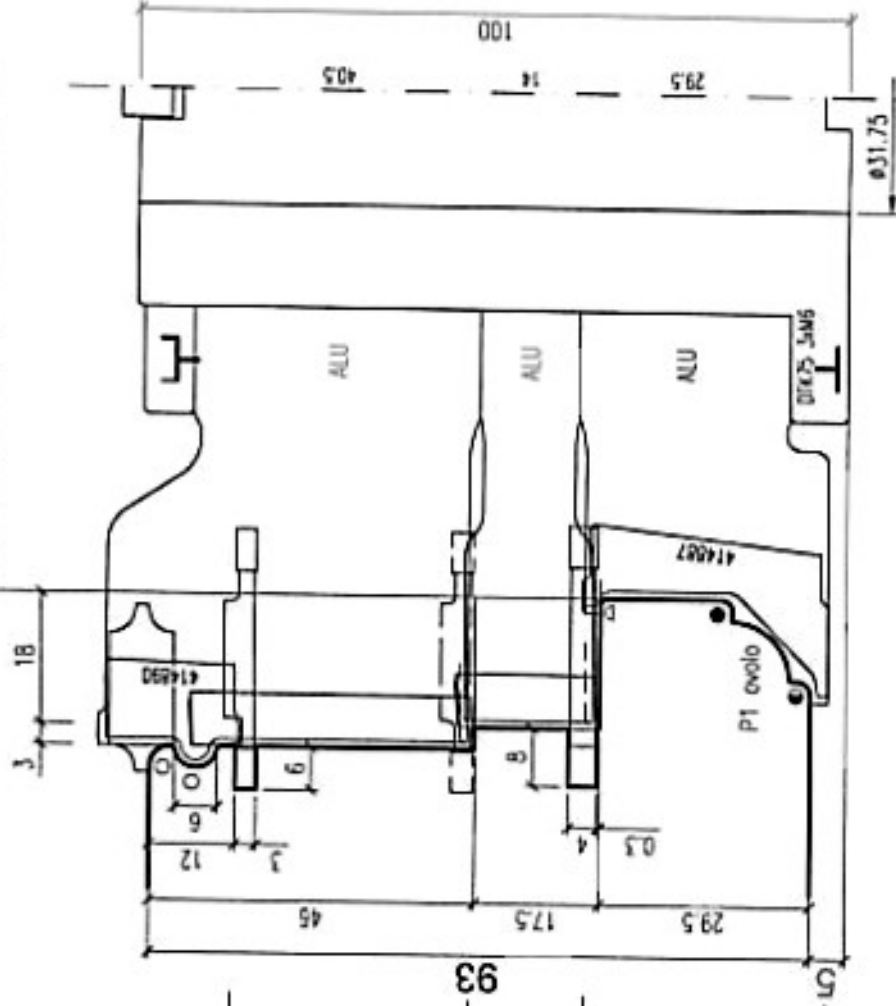

WE 500 1 53

415099

188x53.1/53.6x60

2K20/SB-MC

2WP8/408-MC +2VS2

2KM22/D +2NB35

2NB-AUFN.

WM 410 1

414888

176x19.7/1x60

2WP8/208-MC +2VS2

2NB4

WE 500 1 53

414888

168x34/35x60

2K35/15B-MC

according to section drawing

PBZ = 92777

Z	2
Cutting Angle:	93
20#:	93
MAN (Manual Feed)	
• max./P.P.L.	9100

Refer to protection notice ISO 18016	Quality MC
Tolerances to LEITZ Makrom	Scale 1:1

2020	Date	Name	Plant
drw.	18.12.	LDA	A-4752 REDAU AL530A
ent.	18.12.	LDA	
del.			

leitz

ProfilCut Q set
 W57/93 Lignum Flush Casement
 frame inner profile of head & jambs

Replacement for Previous Leitz No. Filing No.	SE 100 1 53	LeitzDA
Article-No.	SE 100 1 53	
Ident-No.	L 954003/711001	SA01

Ind.	Rev.	Änderungsgrund / MaßNr.	Datum	Name	gepr.
①	1	Prüfblock richtiggestellt	16.03.2021	LDA	LDA

Ø320

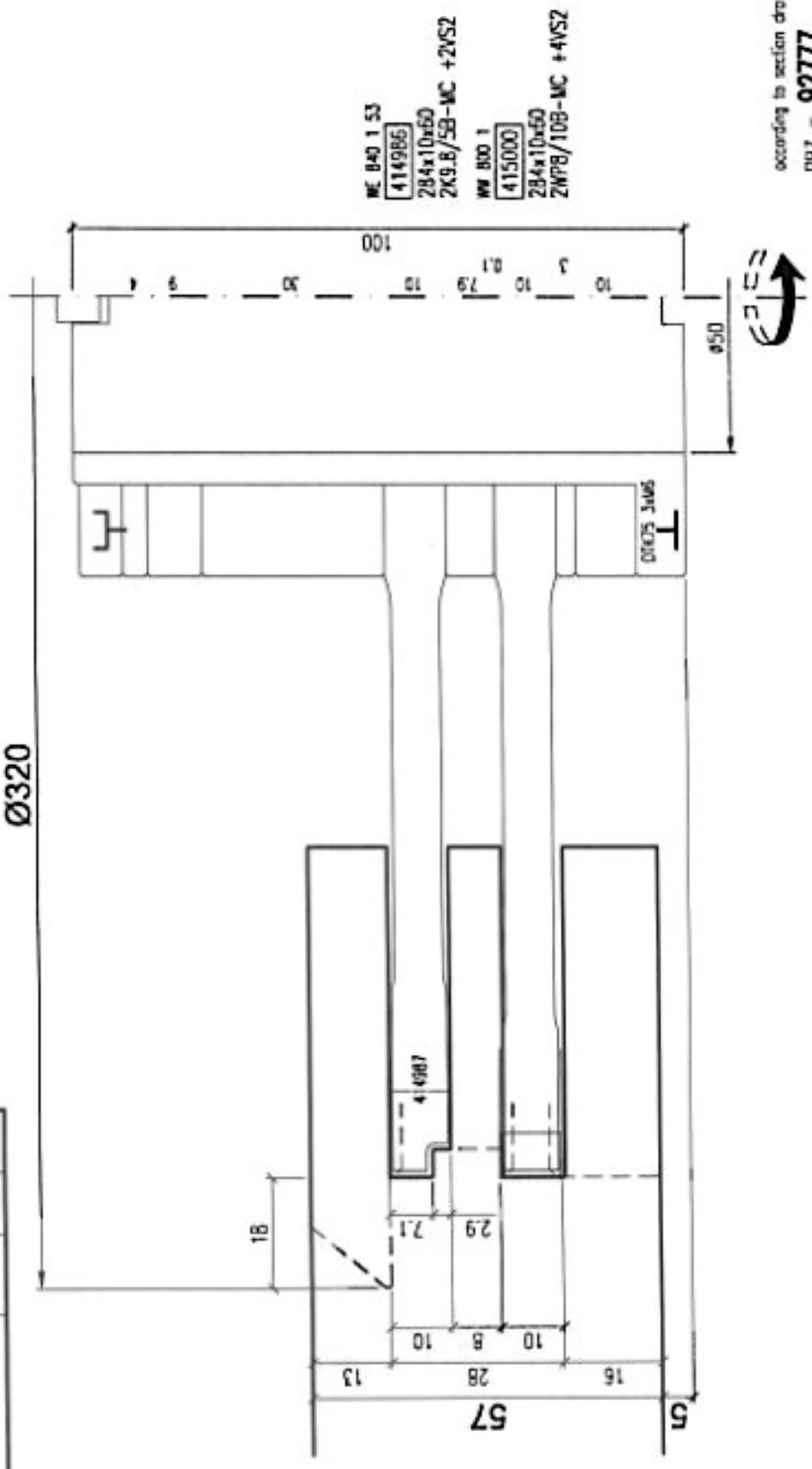

Z	2
Cutting Angle	
ZSk	90
MAN (Manual Feed)	
e max./P.P.M.	6000

- R 1.0
- R 1.5
- ◐ R 2.0
- R 3.0

Refer to protection notice ISO 15015	2020	Date	Name	Plant
	drw.	18.12.	LDA	A-4752 REDAU AUS/DA
	exp.	18.12.	LDA	
Tolerances to DIN 31626				
Quality MC	leitz			
Scale 1:1				
Proficut Q set				
W57/93 Lignum Flush casement sash slot to stile				

Replacement for Previous Leitz No. Filing No.	LeitzDA0
Article-No.	SE 251 1 53
Ident.-No.	L 954008/711003 SA01

Ind.	Anz.	Änderungsgrad / Maßst.	Datum	Name	grupp.
①	1	Profilblock richtiggestellt	18.03.2021	LDA	LDA

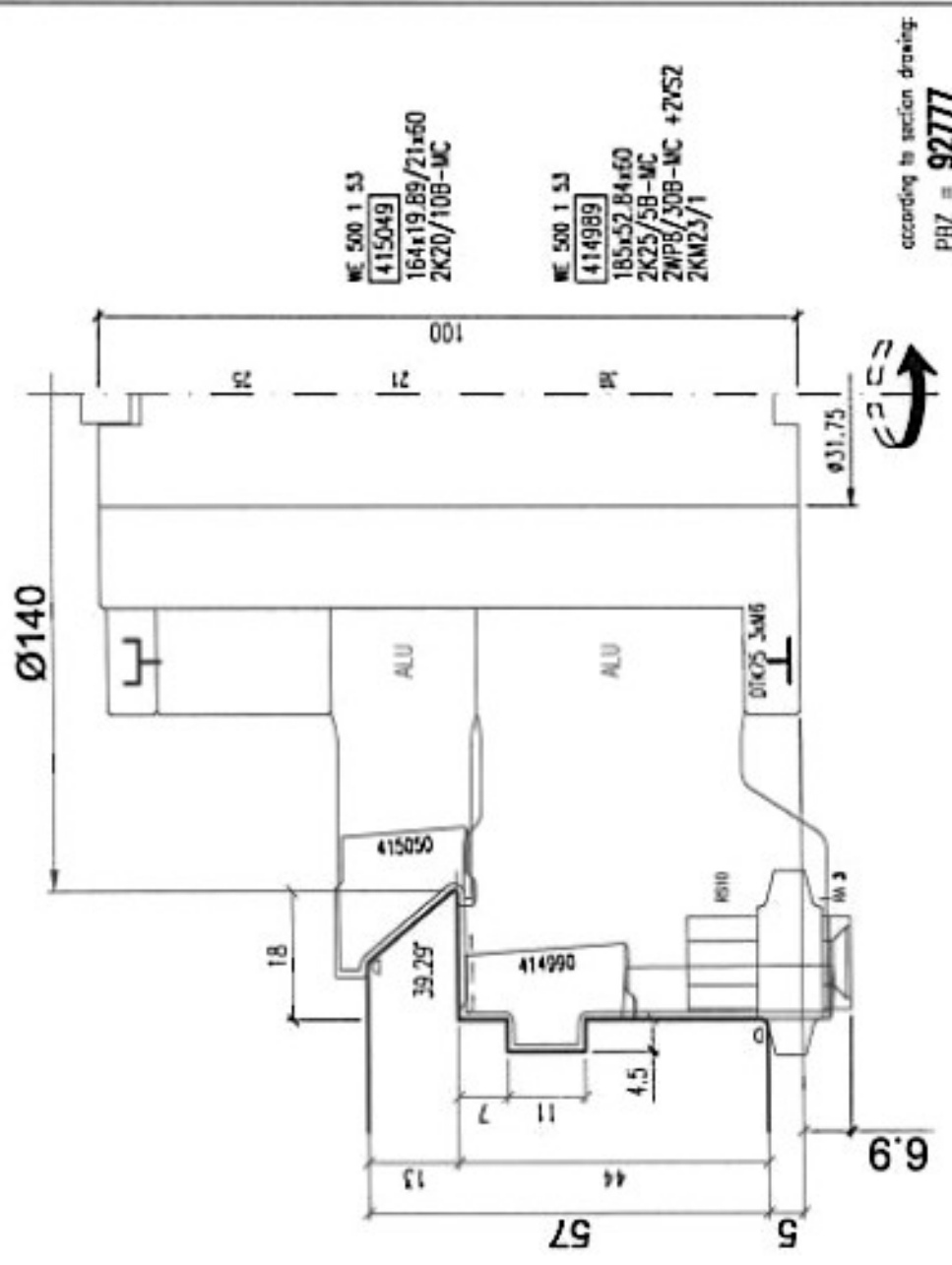

Z	2
Cutting Angle:	
Zone:	90
MAN (Manual Feed)	
v max./RPM 9/200	

- R 1.0
- R 1.5
- R 2.0
- R 3.0

Refer to production notice 60 18016	2020	Date	Name	Plant
	drw.	18.12.	LDA	A-4752 REDAU AUSRIA
	eng.	18.12.	LDA	
Tolerances to IEZ Minimum				
Quality MC				
Scale 1:1				



ProfilCut Q set
N57/93 Lignum Flush Casement
sash inner profile

Replacement for Previous Leitz No.	LeitzCAD
Filing No.	
Article-No.	SE 200 1 53
Ident.-No.	L 954009/711001 SA01

according to section drawing:
PBZ = 92777

Alt. No.	Description	Date	Name	Ens.

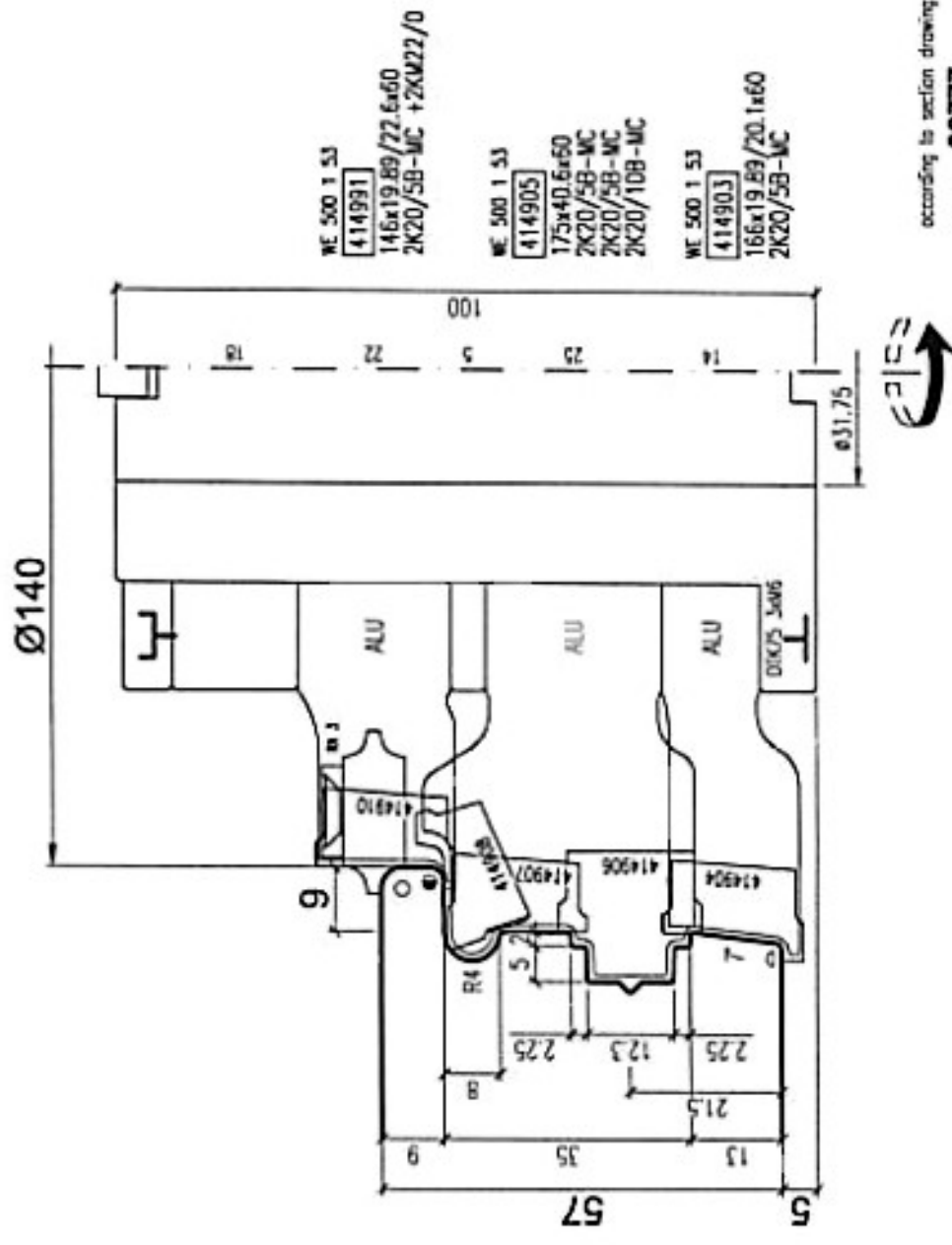

- WE 500 1 53
414931
 146x19.89/72.6x60
 2K20/SB-MC +2KM22/0
- WE 500 1 53
414905
 175x40.6x60
 2K20/SB-MC
 2K20/SB-MC
 2K20/10B-MC
- WE 500 1 53
414903
 166x19.89/20.1x60
 2K20/SB-MC

Z	2
Cutting Angle:	
Spd:	50
MAN (Manual Feed)	
n rev./R.P.M.	9800

- R 1.0
- R 1.5
- ◐ R 2.0
- ◑ R 3.0

Refer to protection notice 60 16216	2021	Date	Name
Tolerances to LEITZ Werknorm	d.w.	16.01.	LDA
Quality MC	exc.	16.01.	LDA
Scale 1:1	det.		



ProfilCut Q set
 W57/93 Lignum Flush Casement
 sash outer profile of sashes and top rail

Replacement for Previous Leitz No. Filing No.	Plant A-4752 REDAU AUSTRIA
Article-No. SE 220 1 53	LeitzCO
Ident.-No. L 954010/711001 SA01	

Alt. No.	Description	Date	Name	Est.

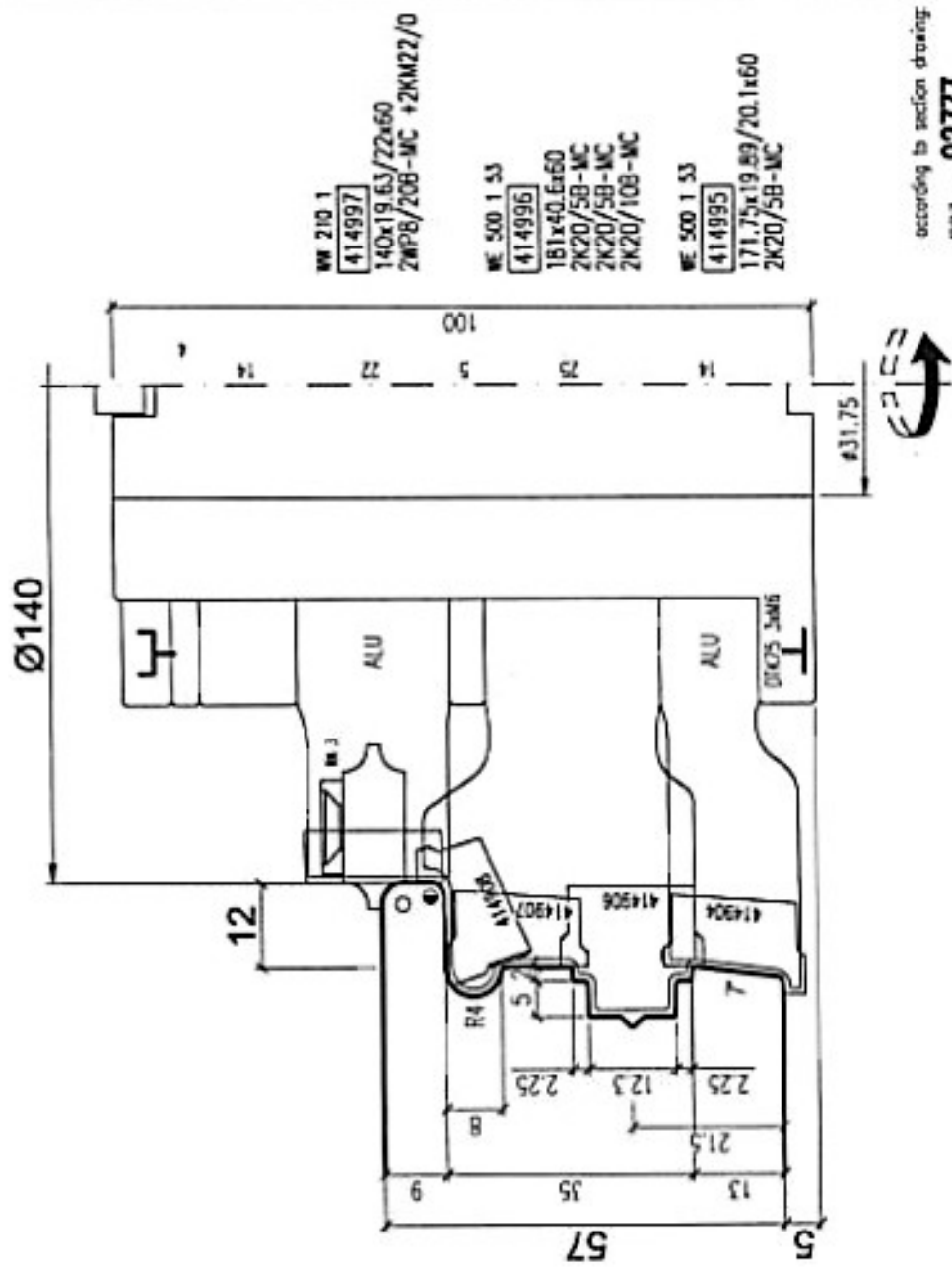

- NW 210 1
 414997
 140x19.63/22x60
 2WP8/208-MC +2KM22/0
- WE 500 1 53
 414996
 181x40.6x60
 2K20/58-MC
 2K20/58-MC
 2K20/108-MC
- WE 500 1 53
 414995
 171.75x19.89/20.1x60
 2K20/58-MC

according to section drawing
 PBZ = 92777

Z	2
Cutting Angle:	90
Zinc:	MAN (Manual Feed)
e max./RPM	9400

- R 1.0
- R 1.5
- R 2.0
- R 3.0

Refer to production notice ISO 14016	2021	Date	Name	Plant	Replacement for Previous Litz No. Filing No.
	drw.	16.01.	LDA	A-4752 REDAU AUSTRIA	
Tolerances to LITZ Messraum	exc.	16.01.	LDA	Leitz ProfilCut Q set N57/93 Lignum Flush Casement sash outer profile bottom rail	Article-No. SE 220 1 53
Qualify MC	det.				Ident.-No. L 954011/711001 SA01
Scale 1:1					

Alt. No.	Description	Date	Name	ess.

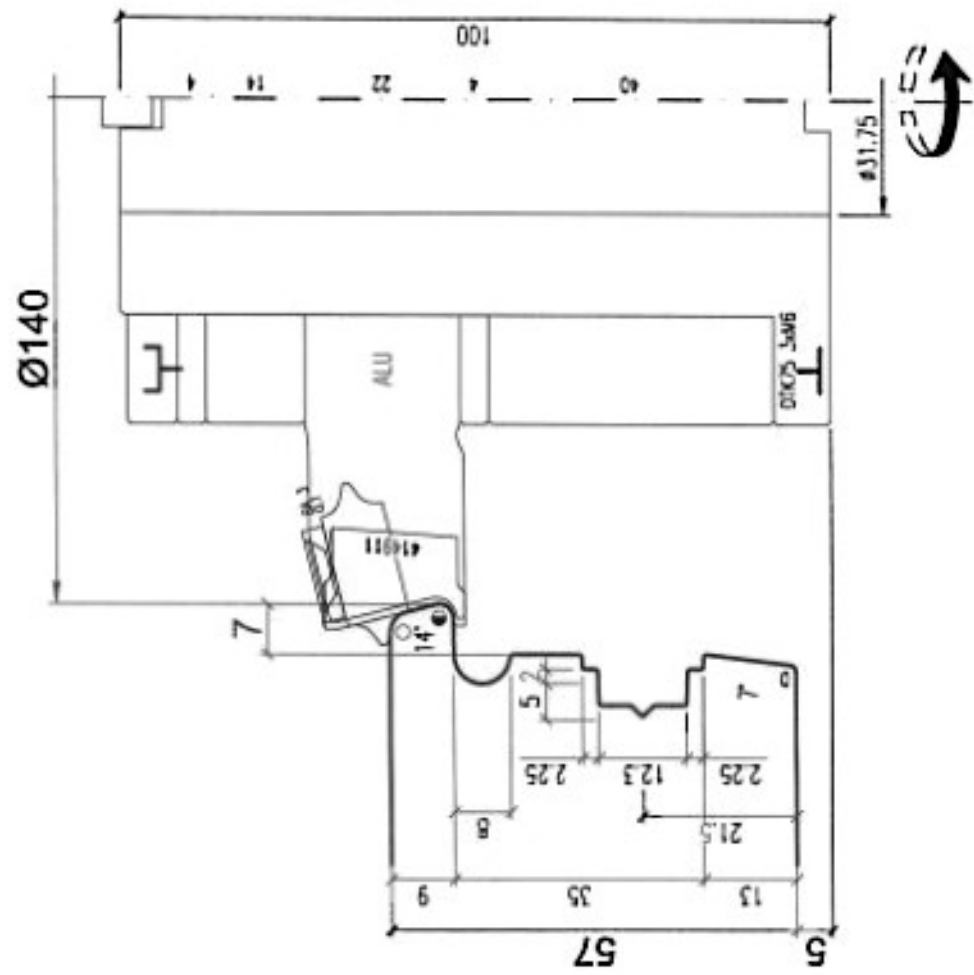

according to section drawing:
PBZ = 92777

Z	2
Cutting Angle:	90
200:	MAN (Manual Feed)
max./RPM	11600

- R 1.0
- R 1.5
- ◐ R 2.0
- R 3.0

Refer to protection notice 60 18016	2021	Date	Name		Plant A-4732 REDAU AUSRIA
	dra.	16.01.	LDA		
	exc.	16.01.	LDA		
Tolerances to ISO Normum	ProfilCut Q set N57/93 Lignum Flush Casement sash outer profile of styles				Article-No. SE 220 1 53 Ident.-No. L 954012/711001 SA01
Quality MC	Replacement for Previous Leitz No. Filing No.				
Scale 1:1	LeitzCAD WE 500 1 53				

Alt. No.	Description	Date	Name	Ext.
① 1	Anzahl der Verbahnungen richtig gestellt	01.01.2021	LDA	LDA

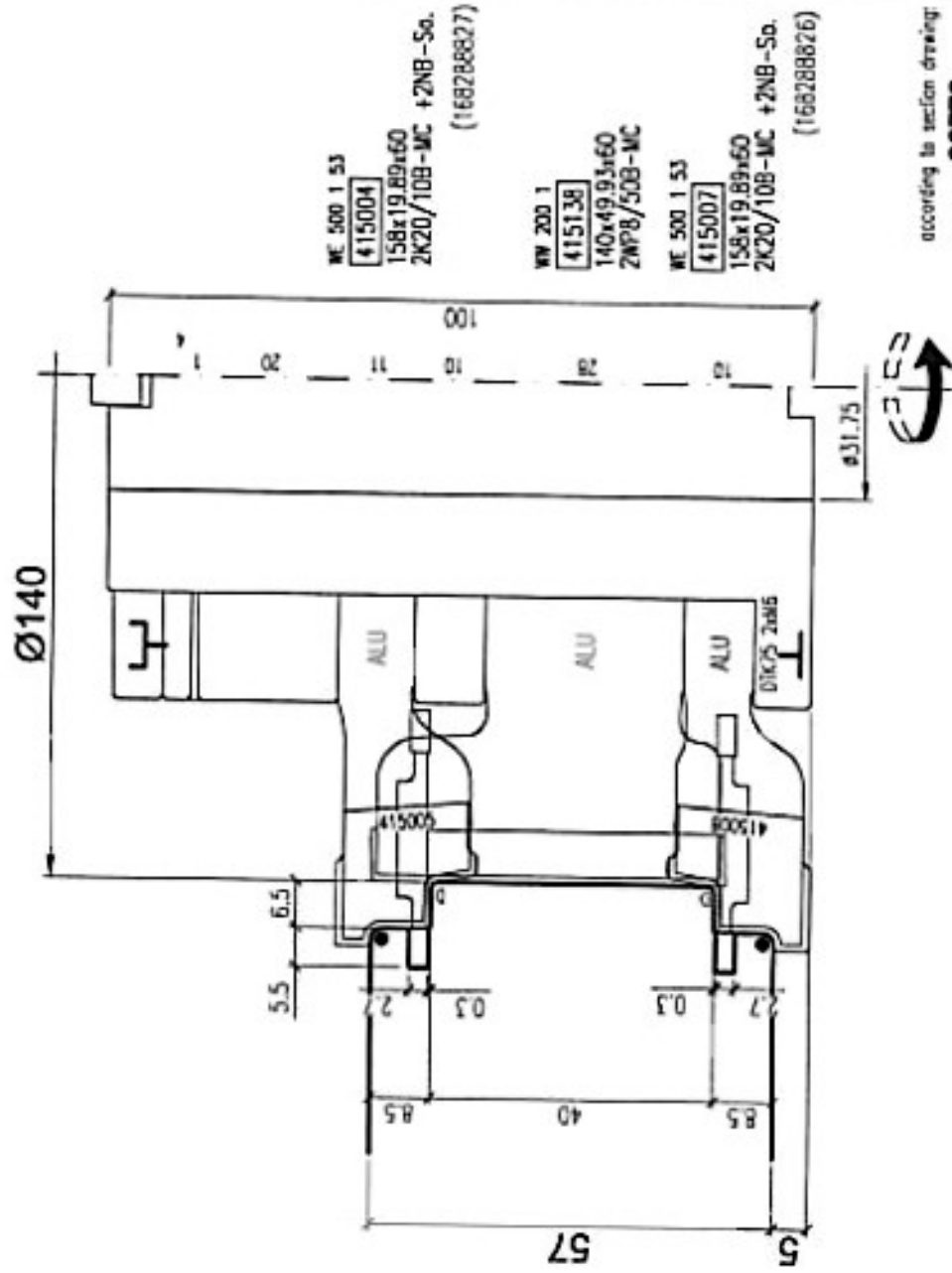

Z	2
Cutting Angle:	
Zth	90
MAN (Manual Feed)	
n max./RPM	10800

- R 1.0
- R 1.5
- R 2.0
- R 3.0

Refer to protection notice 50 14016	2021	Date	Name	Plant
Tolerances to LITZ Networks	drk.	15.01.	LDA	A-4752 REZAU AUSTRIA
Quality MC	end.	18.01.	LDA	
Scale 1:1	del.			

		ProfilCut Q set N57 Lignum box sash window sash outer profile top rail	
		Replacement for Previous Leitz No. Filing No.	
Article-No. SE 200 1 53		Ident-No. L 954013/711001 SA01	

Replacement for Previous Leitz No. Filing No.		Article-No. SE 200 1 53	
Ident-No. L 954013/711001 SA01		Leitz	

Alt. No.	Description	Date	Name	eng.

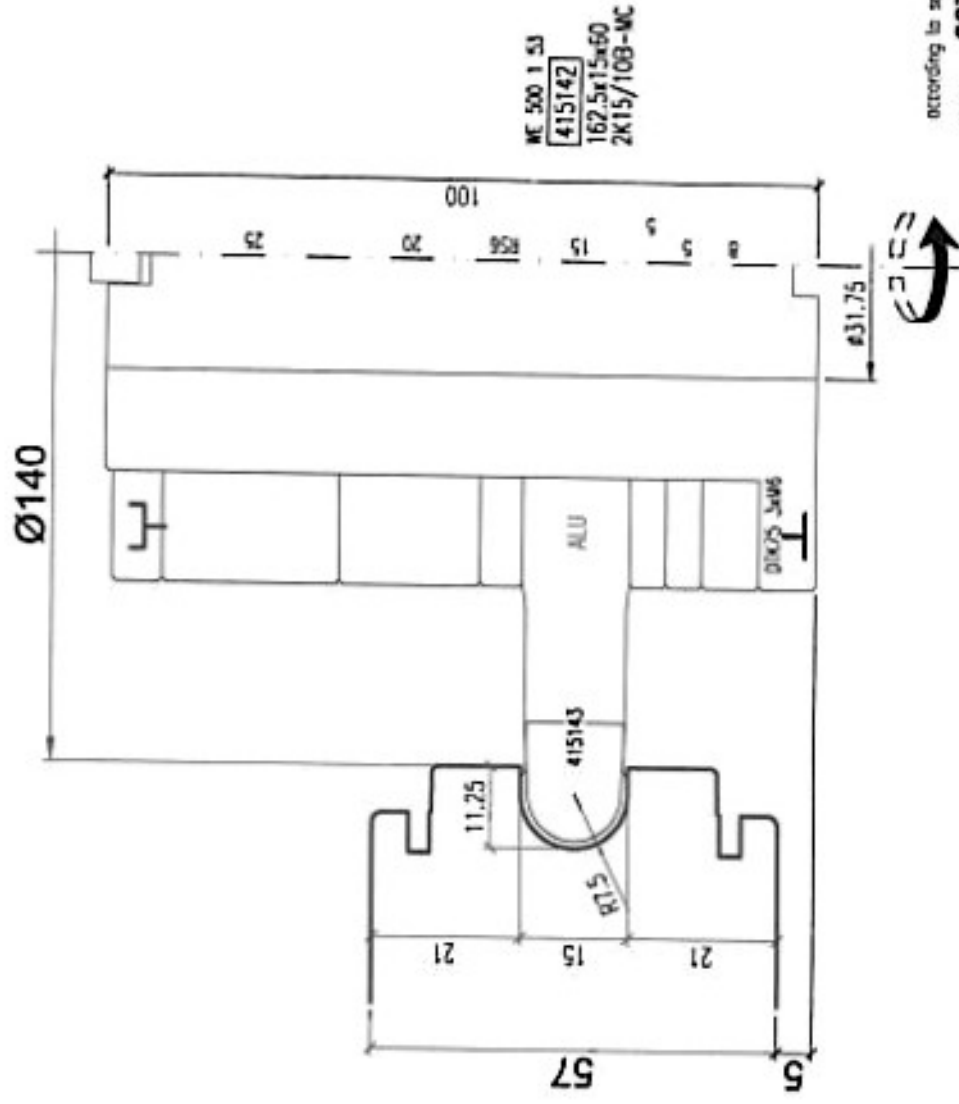

Z	2
Cutting Angle	
Zmk	90
MAN (Manual Feed)	
n max./RPM	10500

- R 1.0
- R 1.5
- R 2.0
- R 3.0

Refer to protection notice 60 15016	2021	Date	Name
Tolerances to L02 Minimum	dra.	18.01.	LDA
Quality MC	exa.	18.01.	LDA
Scale 1:1	del.		

		Plant A-4752 REIDAU AUSTRIA	
ProfilCut Q set N57 Lignum box sash window sash outer profile of stiles			

Replacement for Previous Leitz No. Filing No.	Article-No. SE 220 1 53	LeitzDAO
Ident-No. L 954014/711001	SA01	

Art. No.	Description	Date	Name	Iss.
1	ED war 30	11.03.2017	BAF	BAF

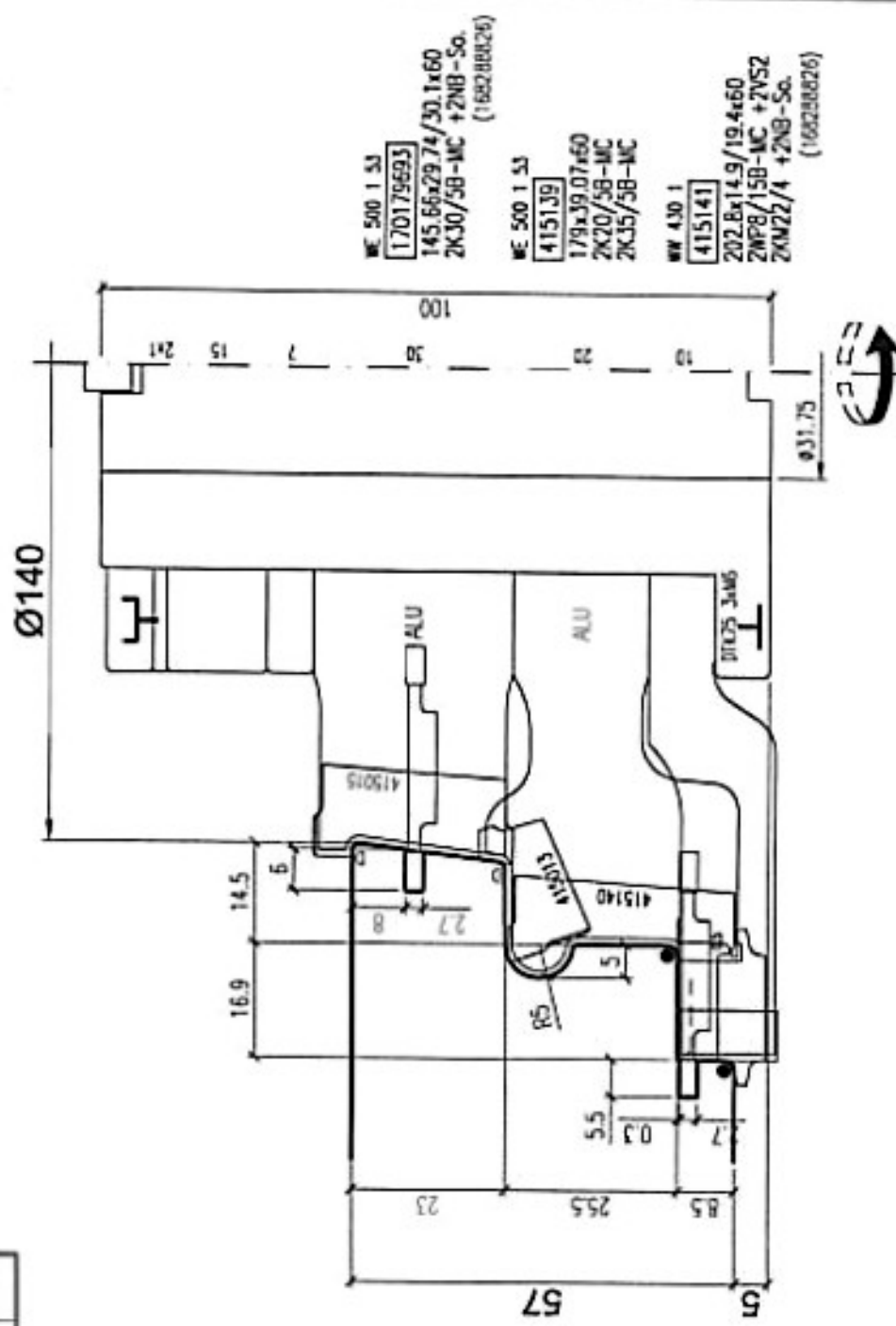

Z	2
Cutting Angle:	
Zoll:	90
MEC	
(Mechanical Feed)	
max:	8400

Refer to protection notice 60 16016	2022	Date	Name	Plant
Tolerances to ISO 2768-mS	drw.	26.01.	BAF	A-4752 REDUO AUSTRIA
Quality MC	exc.	26.01.	BAF	
Scale 1:1	del.			

latz	
ProfilCut Q set	
N57 Lignum box sash window sash outer profile bottom rail	

Replacement for Previous Latz No.	Article-No.	SE 221 2 53	LatzCAD
Filing No.	Ident-No.	L 170179676	SA01

Alt. No.	Description	Date	Name	env.

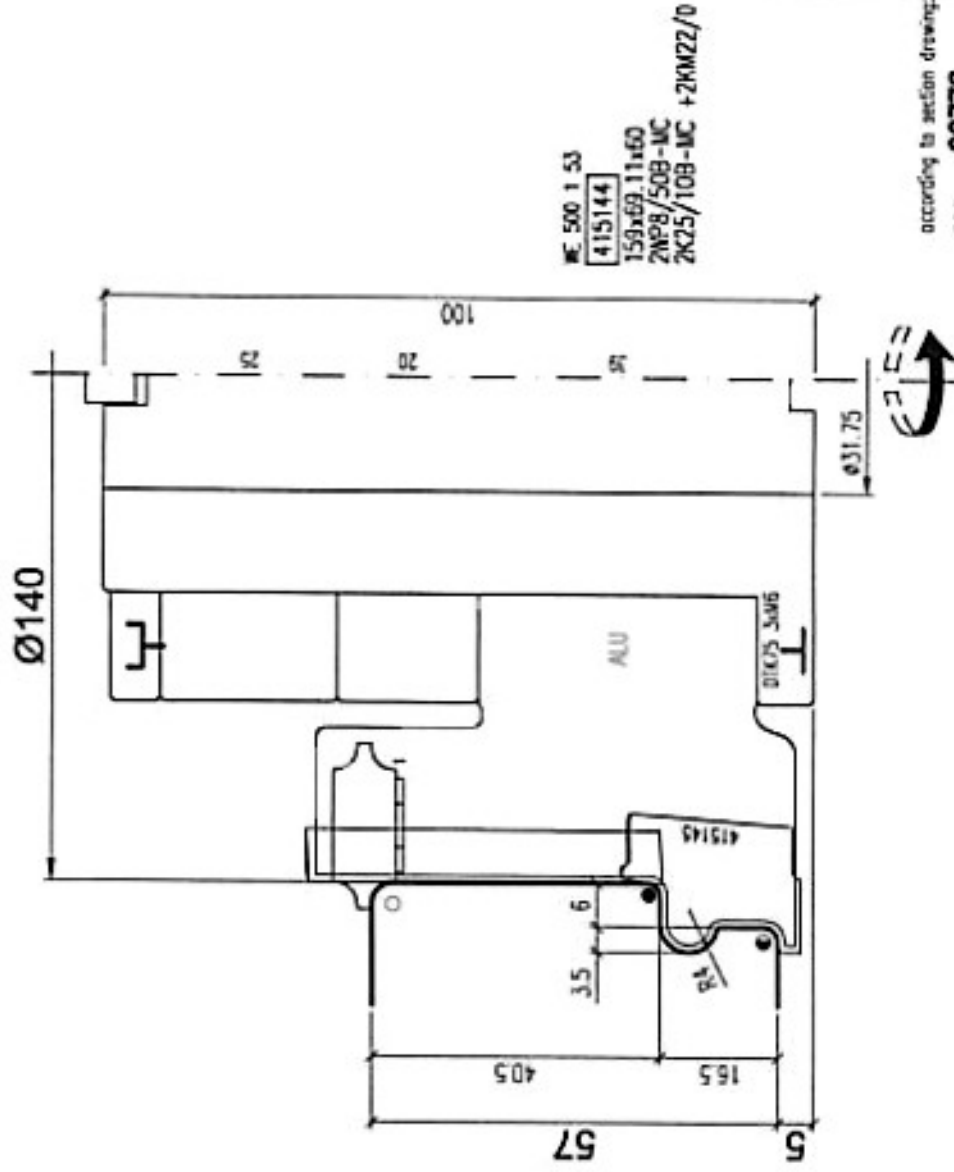

Z	2/2
Cutting Angle:	
Size	50
MAN	(Moved feed)
n max./RPM	10800

- R 1.0
- R 1.5
- R 2.0
- R 3.0

Refer to protection notice ISO 15016	2021	Date	Norma
Tolerances to LEITZ Normen	d.w.	16.01.	LDA
Quality MC	enc.	18.01.	LDA
Scale 1:1	det.		

leitz	
ProfilCut Q set	
W57/93 Lignum Flush casement door sash outer profile of stiles and top rail	
Plant	A-4752 REDBAG AUSTRIA

Replacement for Previous Leitz No. Filing No.	LeitzOO
Article-No.	SE 220 1 53
Ident.-No.	L 954016/711001 SA01

Alt. No.	Description	Date	Name	exc.

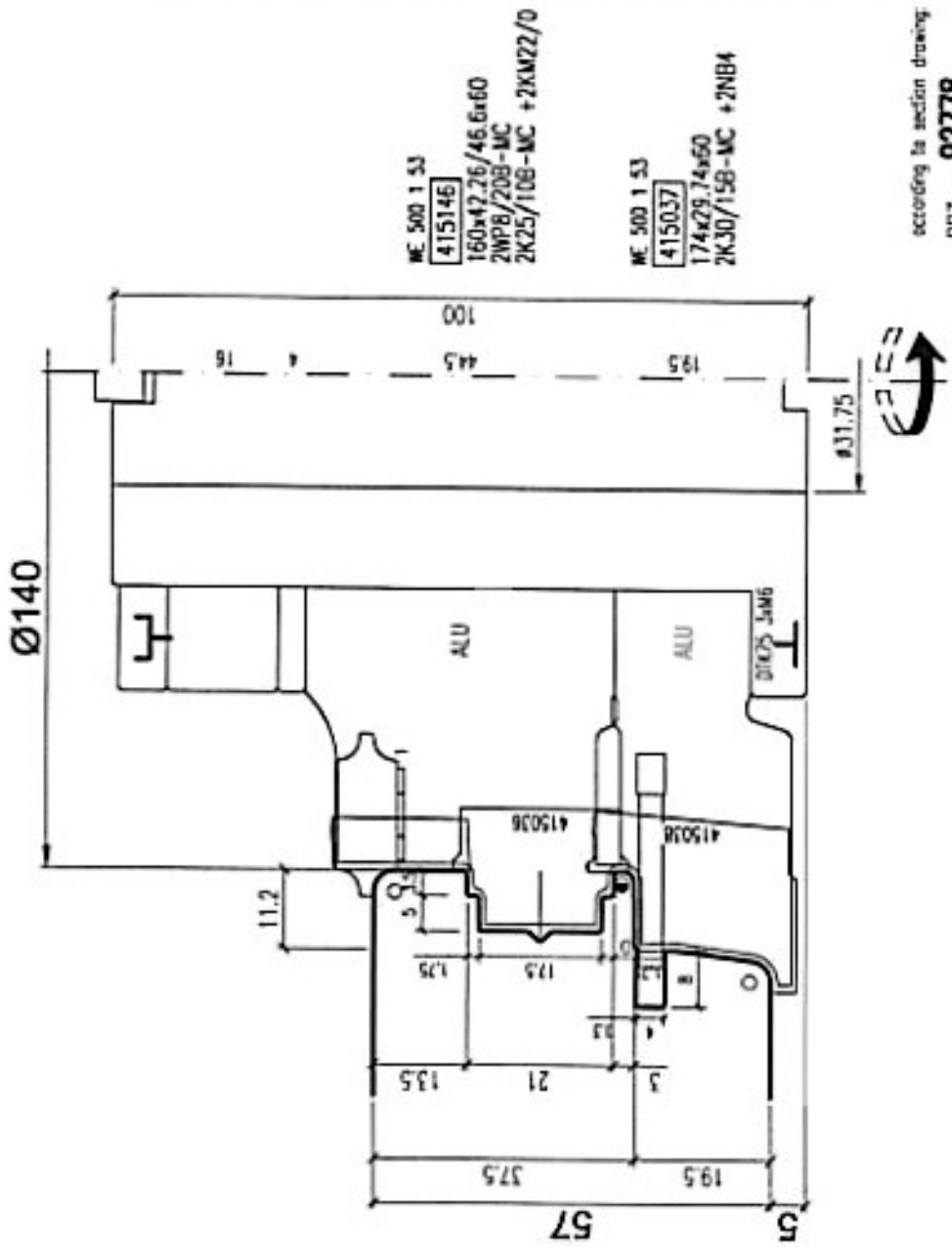

Z	2
Cutting Angle	90
Zinc	90
MAN (Manual Feed)	
n max./P.P.L.	9800

- R 1.0
- R 1.5
- ⊙ R 2.0
- R 3.0

Refer to protection notice	ISO 16016
Tolerances to	LEITZ Messnorm
Quality	MC
Scale	1:1

2021	Date	Name
dra.	16.01.	LDA
exc.	16.01.	LDA
del.		

leitz

ProfilCut Q tool

N57/93 Lignum Flush casement door
sash outer profile right side for french doors

Plant	A-0252 BEDAU AUSTRIA
Replacement for Previous Leitz No. Filing No.	
Article-No.	SE 220 1 53
Ident.-No.	L 954018/711001
	SA01

Alt. No.	Description	Date	Name	Ens.

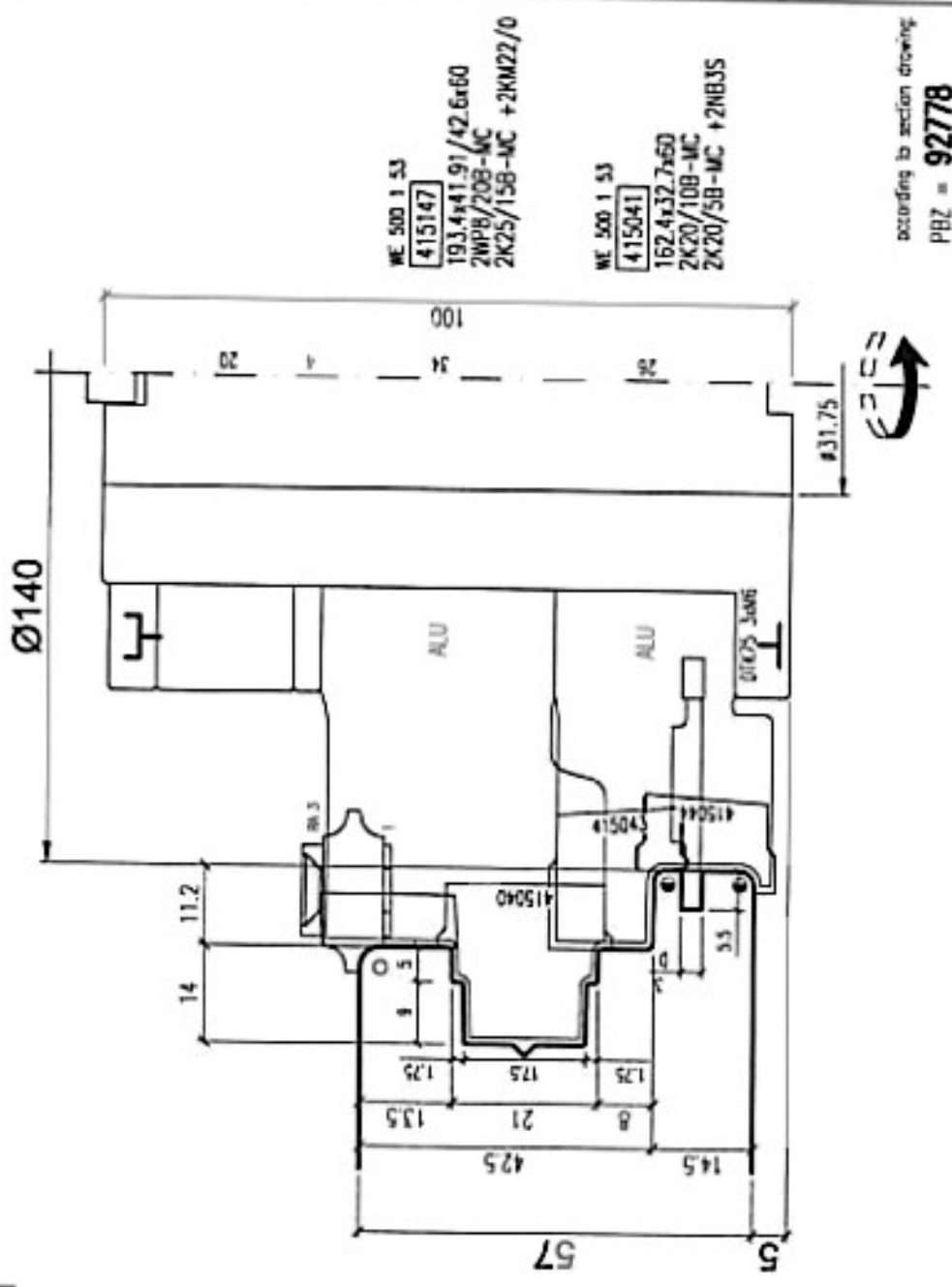

Z	2/2
Cutting Angle	90
Zfile	00
MAN (Manual Feed)	
x max./z.p.M.	8800

Refer to protection notice ESD 16016	2021	Date	Name	Plant
Tolerances to LETZ Normen	dra.	16.01.	LDA	A-4752 REIDAU AUSRIA
Quality MC	est.	16.01.	LDA	leitz ProfilCut Q tool N57/93 Lignum Flush casement door sash outer profile left side for french doors
Scale 1:1	det.			

Replacement for Previous Leitz No.	Article-No.	SE 220 1 53	LeitzCO
Filing No.	Ident.-No.	L 954019/711001	SA01

Alt. No.	Description	Date	Name	est.
1	BD wof 3D	11.03.2022	BAF	BAF

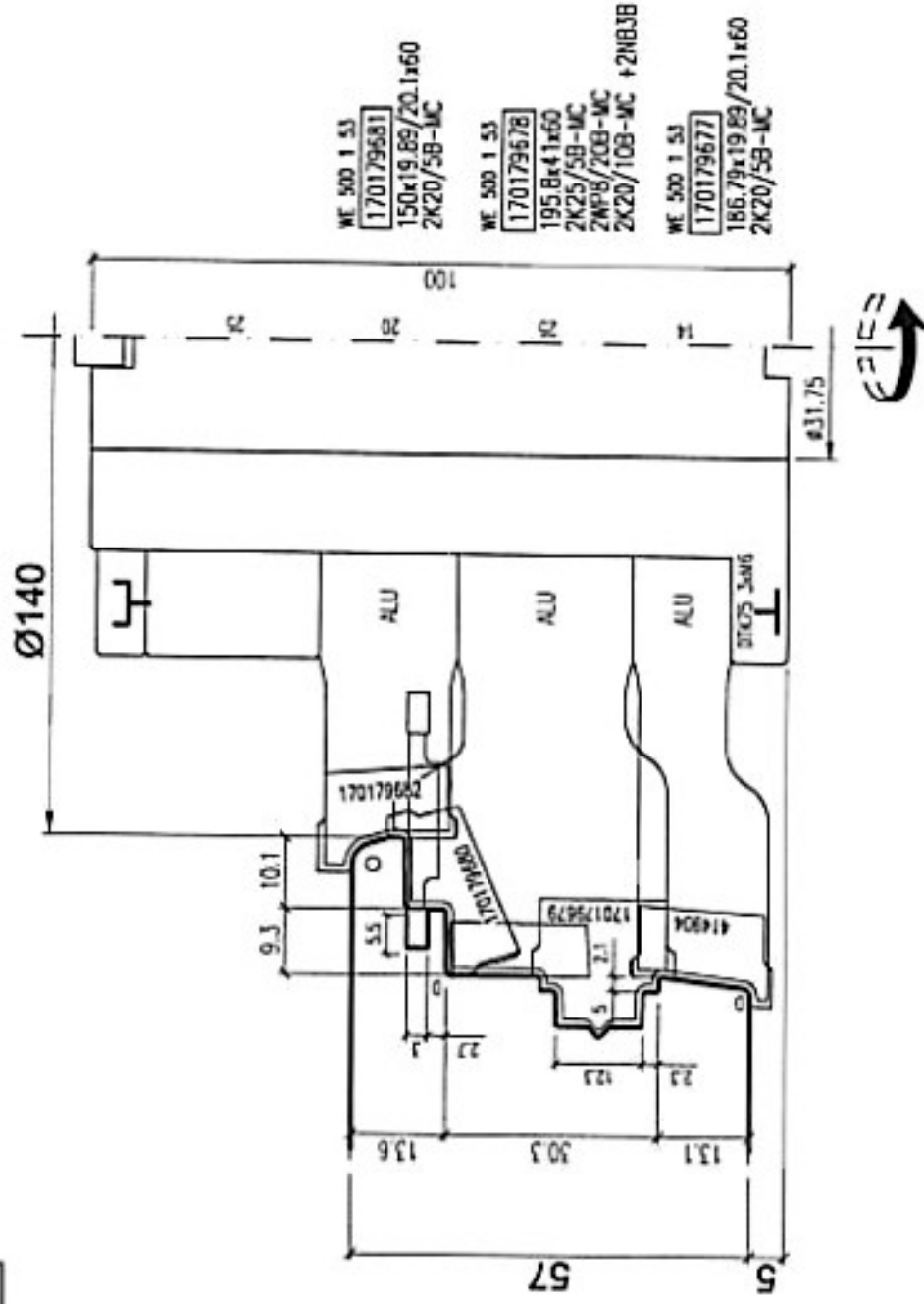

Z	2
Cutting Angle:	
29k:	90
MAN (Manual Feed)	
s max:	8700

○ R 1.0
 ○ R 3.0

Refer to protection notice ES 15016	2022	Date	Name
Tolerances to LEITZ Normen	drw.	18.01.	BAF
Quantity MC	exs.	18.01.	BAF
Scale 1:1	del.		

leitz

ProfilCut Q set
 W57/93 Lignum Flush Casement
 stormproof sash outer profile

Plant
A-4752
REDAU
AUSTRIA

Replacement for
Previous Leitz No.
Filing No.

Article-No. SE 220 1 53

LeitzOO

Ident-No. L 170179671

SA01

Ø320

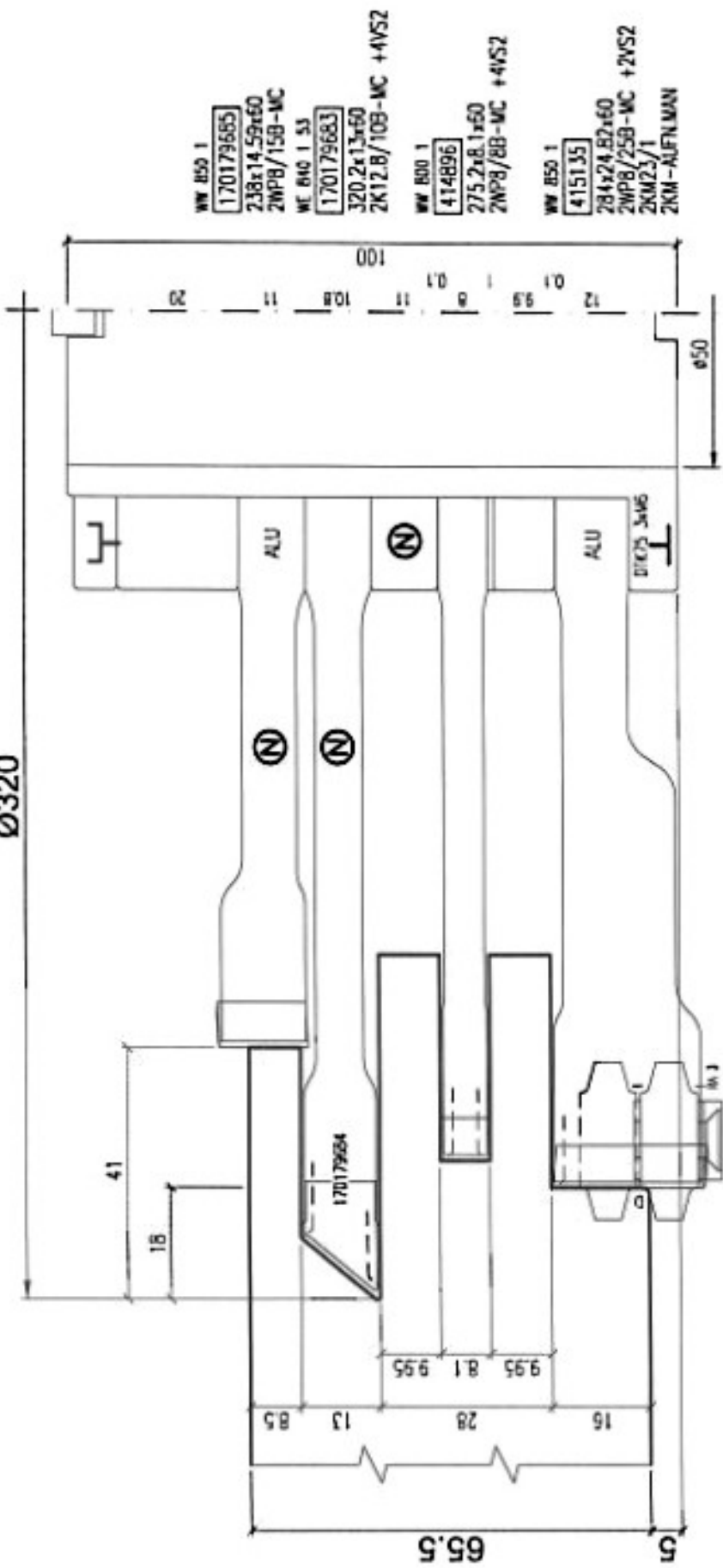

ⓃNEW

To be assembled with existing parts at the customer from 954007/711003

Z	2
Cutting Angle:	
29#:	60
MAN (Verrußteil)	
Y-mas.:	5.500

Refer to protection notice ISO 15016	2022	Date	Name	Plant
Tolerances to LEITZ Normen	dra.	15.01.	BAF	A-4752 REDAU AUSTRIA
Quality MC	era.	18.01.	BAF	
Scale 1:1	del.			

leitZ	
ProfilCut Q set	
N66.5/93 Lignum Flush Casement sash tenon on top and bottom part	

Replacement for Previous Leitz No.	Article-No.	SE 250 1 53	LeitzOO
Filing No.	Ident-No.	L 170179672	SA01

AL. No.	Description	Date	Name	ess
1	BD vor 30	11.03.2022	BAF	BAF

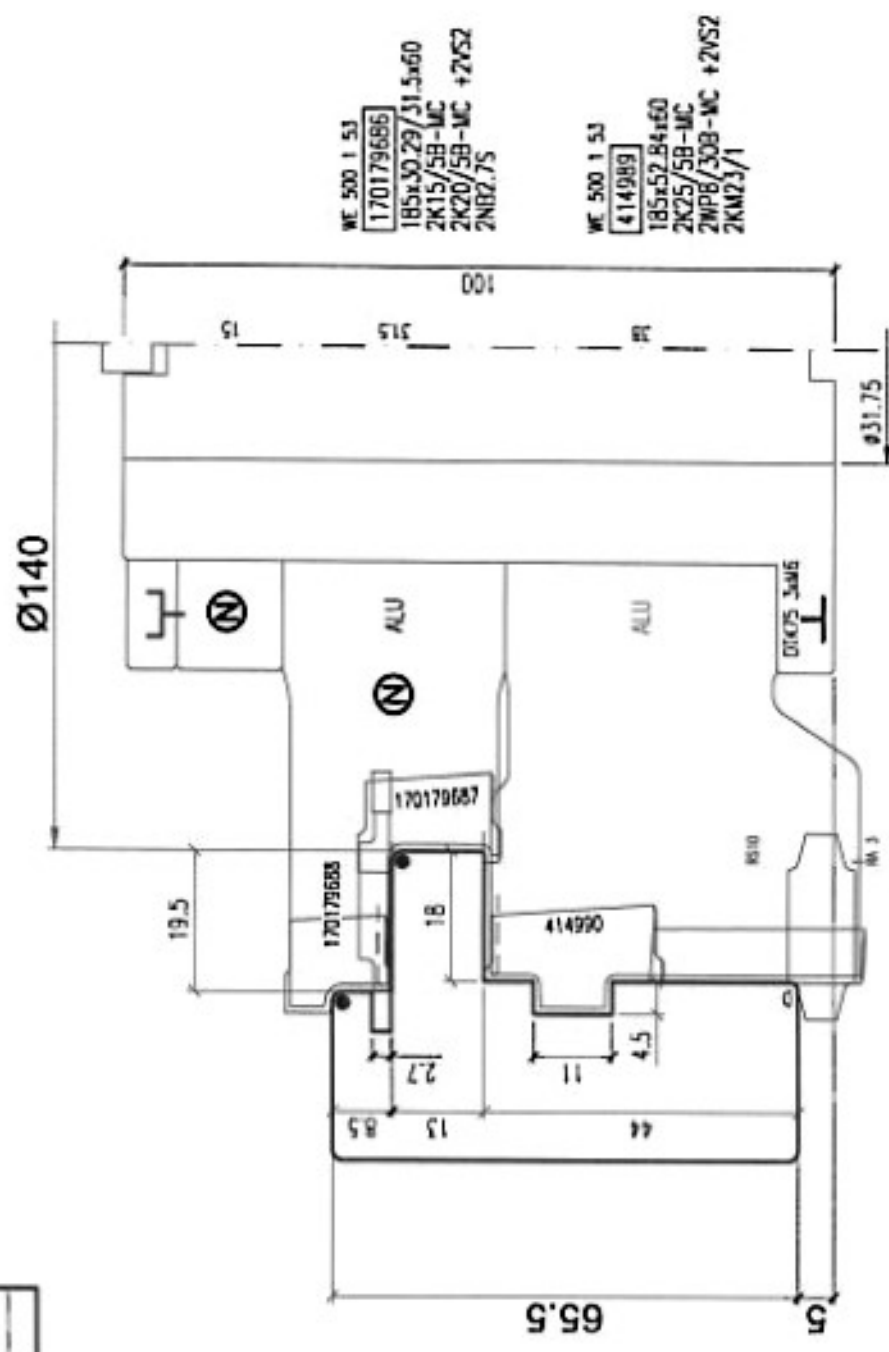

NNEW

To be assembled with existing parts at the customer from 954009/711001

Z	2/2
Cutting Angle:	
Zfkr:	90
MAN (Manual Feed)	
9200	

Refer to production notice 650 18018	Date	Name	Plant
Tolerances to LEITZ Normen	15.01.	BAF	A-4752 REDAU ALSTRA
Quality MC	15.01.	BAF	LeitzCAD
Scale 1:1	det.		
leitz			
ProfilCut Q set			
M66.5/93 Lignum Flush Casement sash inner profile			
Article-No. SE 200 1 53		Ident-No. SA01	
L 170179673		SA01	

Art. No.	Description	Date	Name	ext.
1	EO war 3D	11.03.2022	BAF	BAF

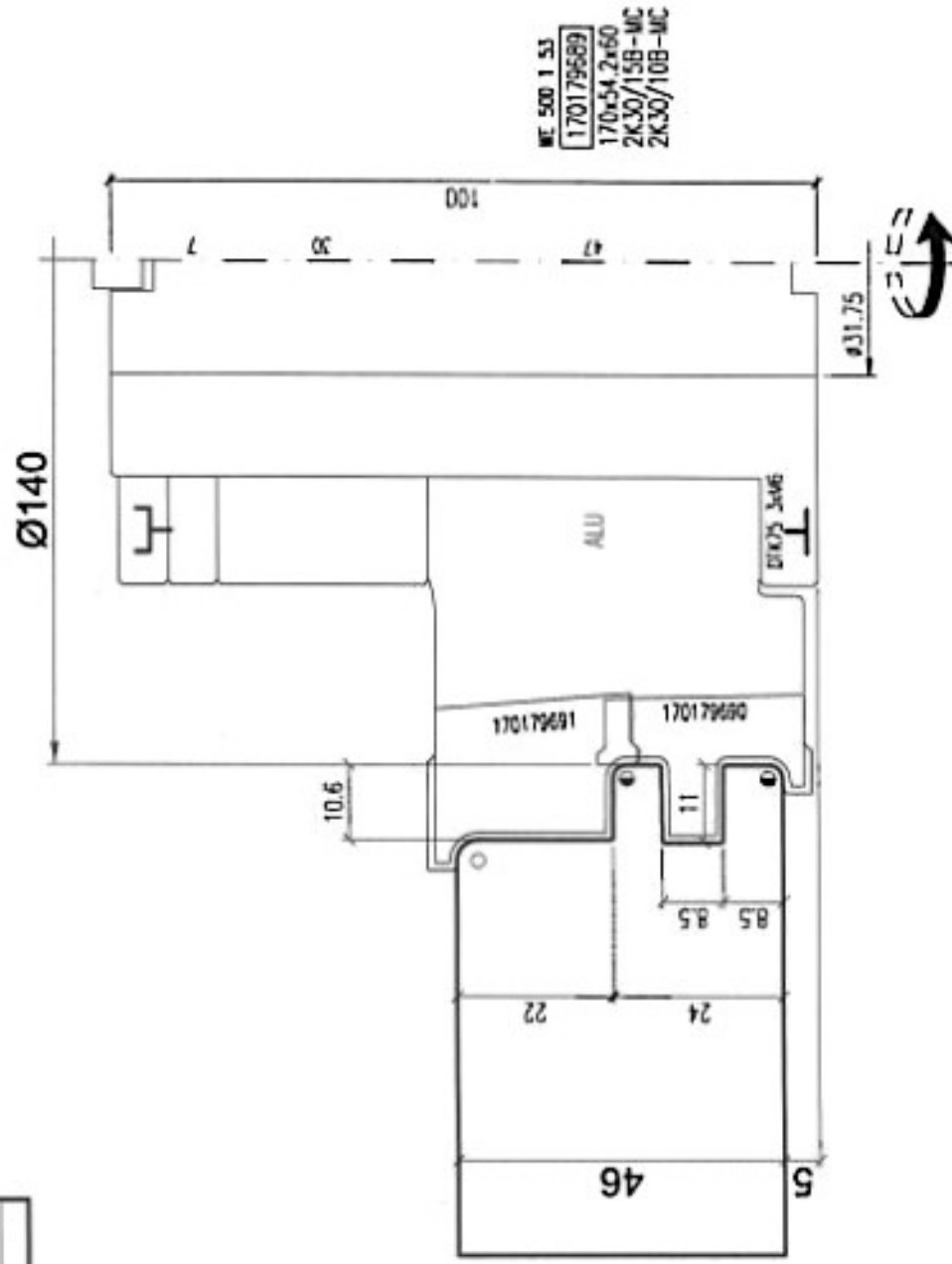

Z	2/2
Cutting Angle	90
25%	90
MAN (Manual Feed)	
n max.	10100

Refer to publication notice ISO 16016	2022	Date	Name
Tolerances in ISO 2768-mS	drw.	18.01.	BAF
Quality MC	est.	18.01.	BAF
Scale 1:1	del.		

leitz		Plant
ProfilCut Q set frame cill groove		A-4752 REDAU AUSTRIA

Replacement for Previous Leitz No. Filing No.	Article-No.	SE 540 1 53	Leitz-Obj
	Ident-No.	L 170179674	SA01

Alt. No.	Description	Date	Name	ext.



Profilbezeichnung lt. Schnitt
 P8Z = 92778

Z	2/2
Cutting Angle:	
Zfile	50
MAN (Manual Feed)	
8700	

Refer to production notice ISO 16016	2022	Date	Name	Plant
Tolerances to UST Normen	drw.	10.02.	BAF	A-4752 REDAU AUSTRIA
Quality MC	exc.	10.02.	BAF	
Scale 1:1	det.			

		ProfilCut Q set N57 Lignum box sash window horn profile 1	
		Replacement for Previous Leitz No. Filing No.	Article-No.
Ident.-No. L 954032/711004 SA01		LeitzD&D SE 540 1 53	

P	St	IdNo.	Article No.	Title	BK	Dimension	Comment
1	L	415134	WE 890 1 53	ProfilCut Q cutterhead		MC:278.2x36.1x60,Z2/2,V2	
2	L	160005974	TR 100 0	Spacer		90x19.9x60,3NL,DTK75	
3	L	28020	TR 100 0	Spacers		90x0.1x60,6NL,DTK75	
4	L	414879	WE 840 1 53	ProfilCut Q cutterhead		MC:284.2x17.6x60,Z2,V2	
5	L	160006130	TR 100 0	Spacer		90x15.9x60,3NL,DTK75	
6	L	28020	TR 100 0	Spacers		90x0.1x60,6NL,DTK75	
7	L	414059	WE 890 1 53	ProfilCut Q cutterhead		MC:320.2x19.8x60,Z2,V2	
8	L	28679	TB 260 0	Sleeves with safety key		90/60x100x50	

Spare parts

6	L	5115		Turnblade spurs VS 2		TC:19x2	
2	L	8293		Corner knives		KM220, R3	
2	L	414060		ProfilCut Q knife		MC:20x21x2.4,PT11.5	
2	L	414880		ProfilCut Q knife		MC:17.6x21.5x2.4,PT9	
2	L	415024		ProfilCut Q knife		MC:20.2x16x2.4,PT6.7	
2	L	415025		ProfilCut Q knife		MC:20.1x15.5x2.4,PT6.1	



2022	date	name	Variable attributes
prov.	29.03.	REH	BFT = B BO = 50.000 BZH = 0.000 KLH = 100.00 NH = 5.00 PBZ = 92777
exam.			
det.			

ProfilCut Q tool-set
MC:RE,Z2,d50,3-TLG,92777

50761 Leitz Tooling UK Ltd
Order: K 25 22 35472 1-51 / Pos. 1

Id.no.: L 954000 / 711003
Art.no.: SE 150 1 53

page

1(31)

P	St	IdNo.	Article No.	Title	BK	Dimension	Comment
1	2	L 5115	TM 480 0	Turnblade spurs VS 2		TC:19x2	
2	2	L 7808	TK 500 0	Screw Torx		M 5x8.5-12.9, T20	
3	2	L 320007570	TK 599 0	Spezial part		M 5X0.80	
4	2	L 451042	TE 540 1	KM22/3 Abrundm. R2			
5	2	L 320006328	TK 599 0	Spezial part		M 6X1.00	
6	2	L 160001888	TE 111 0	ZM11/1B-MC "Typ A2"			
7	2	L 160001862	TE 111 0	WP8/20B-MC "Typ A2"			
Spare parts							
	2	L 5115		Turnblade spurs VS 2	TC:19x2		
	2	L 8309		Corner knives	KM22/3, R2		
	2	L 601632		Turnblade knives WP8/20B-MC	MC:19.7x8x1.5;50°		
	2	L 601648		Turnblade knives ZM11/1B-MC	MC:21x8x1.5;50°		



2022	date	name	Variable attributes
prov.	29.03.	REH	
exam.			
det.			

Turnblade bevel tenoning disc
MC:274.39x34.18/34.5x60_Z2/ZV2

50761 Leitz Tooling UK Ltd
Order: K 25 22 35472 1-51 / Pos. 2
Id.no.: L 954001
Art no.: WW 860 1
page
2(31)

P	St	IdNo.	Article No.	Title	BK	Dimension	Comment
1	1	L 28638	TR 100 0	Spacer		90x20x60,6NL_OTK75	
2	1	L 160005914	TR 100 0	Spacer		90x6x60,3NL_OTK75	
3	1	L 28022	TR 100 0	Spacers		90x0.5x60,6NL_OTK75	
4	1	L 414965	WW 800 1	Turnblade slotting disc		MC:278x14.5x60,ZZV4	
5	1	L 160005974	TR 100 0	Spacer		90x19.9x60,3NL_OTK75	
6	1	L 28020	TR 100 0	Spacers		90x0.1x60,6NL_OTK75	
7	1	L 414884	WW 800 1	Turnblade slotting disc		MC:320x14.5x60,ZZV4	
8	1	L 160005805	TR 100 0	Spacer		90x13x60,3NL_OTK75	
9	1	L 28022	TR 100 0	Spacers		90x0.5x60,6NL_OTK75	
10	1	L 29679	TB 260 0	Sleeves with safety key		90/60x100x50	

Spare parts

8 L 5115 Turnblade spurs VS 2 TC:19x2
 4 L 260000381 711063 Wendemesser 8 mm MC MC:14.1x8x1.5.;50*



2022	date	name	Variable attributes
prov.	29.03.	REH	BFT = B BO = 50.000 BZH = 0.000 KLH = 100.00 NH = 5.00 PBZ = 92777
exam.			
dat.			

Turnblade toolset RS
 MC:RE,ZZ,d50,2-TLG.,92777

50761 Leitz Tooling UK Ltd
 Order: K 25 22 35472 1-51 / Pos. 3

Id.no.: L 954002 / 711003

Art.no.: SW 154 1

page

3(31)

P	St	IdNo.	Article No.	Title	BK	Dimension	Comment
1	L	415099	WE 500 1 53	ProfilCut Q cutterhead		MC:188x53.1/53.6x60.ZZ/2,V2	
2	L	414888	WW 410 1	Turnblade rebating cutterhead		MC:176x19.7x60.ZZ,V2	
3	L	414886	WE 500 1 53	ProfilCut Q cutterhead		MC:168x34/35x60.ZZ	
4	L	11002142	700338 TB 260 0	Sleeve w. fl.,end r.& anti tw.		90/60x100x31.75	

Spare parts

4	L	5115		Turnblade spurs VS 2		TC:19x2	
2	L	8293		Corner knives		KM220, R3	
2	L	8322		Turnblade-grooving-knife NB3S		TC:36x20x3	
2	L	8323		Turnblade-grooving-knife NB4		TC:36x20x4	
2	L	414887		ProfilCut Q knife		MC:35.2x22.9x2.4,PT13.7	
2	L	414890		ProfilCut Q knife		MC:20.2x15.5x2.4,PT4	
2	L	601632		Turnblade knives WP8/20B-MC		MC:19.7x8x1.5,;50°	
2	L	601636		Turnblade knives WP8/40B-MC		MC:40x8x1.5,;50°	



2022	date	name	Variable attributes
prov.	29.03.	REH	BFT = 8 BO = 31.750 BZH = 0.000 KLH = 100.00 NH = 5.00 PBZ = 92777
exam.			
del.			

ProfilCut Q tool-set
MC:RE.ZZ.d31.75.3-TLG..92777

50761 Leitz Tooling UK Ltd
Order: K 25 22 35472 1-51 / Pos. 41
Id.no.: L 954003 / 711001
Art.no.: SE 100 1 53

P	St	IdNo.	Article No.	Title	BK	Dimension	Comment
1	2	L 5115	TM 480 0	Turnblade spurs VS 2		TC:19x2	
2	2	L 7808	TK 500 0	Screw Torx		M 5x8.5-12.9, T20	
3	2	L 320007570	TK 599 0	Spezial part		M 5X0.80	
4	2	L 451043	TE 540 1	KM22/3F Abrundm. R2			
5	2	L 320006328	TK 599 0	Spezial part		M 6X1.00	
6	2	L 160001812	TE 111 0	WPB/50B-MC			

Spare parts

2	L	5115	Turnblade spurs VS 2	TC:19x2
2	L	8310	Corner knives	KM22/3F, R2F
2	L	601638	Turnblade knives WPB/50B-MC	MC:50x8x1.5.; 50°



2022		Variable attributes	
prov.	dato	name	
29.03.		REH	
exam.			
det.			

Turnblade bevelling cutterhead
MC:194.19x49.64/53x60,ZZ,VZ

50761 Leitz Tooling UK Ltd
Order: K 25 22 35472 1-51 / Pos. 5
Id.no.: L 954004
Art.no.: WW 310 1
page 4(31)

P	St	IdNo.	Article No.	Title	BK	Dimension	Comment
1	L	28638	TR 100 0	Spacer		90x20x60,6NL_DTK75	
2	L	28635	TR 100 0	Spacer		90x4x60,6NL_DTK75	
3	L	28634	TR 100 0	Spacer		90x3x60,6NL_DTK75	
4	L	415047	WE 890 1 53	ProfilCut Q cutterhead		MC:320.2x19.89x60,Z2,V2	
5	L	28023	TR 100 0	Spacers		90x1x60,6NL_DTK75	
6	L	160005913	TR 100 0	Spacer		90x12.9x60,3NL_DTK75	
7	L	28020	TR 100 0	Spacers		90x0.1x60,6NL_DTK75	
8	L	414896	WW 800 1	Turnblade slotting disc		MC:275.2x8.1x60,Z2V4	
9	L	28023	TR 100 0	Spacers		90x1x60,6NL_DTK75	
10	L	160005928	TR 100 0	Spacer		90x9.9x60,6NL_DTK75	
11	L	28020	TR 100 0	Spacers		90x0.1x60,6NL_DTK75	
12	L	415135	WW 850 1	Turnblade tenoning disc		MC:284x24.82x60,Z2V2	
13	L	29679	TB 260 0	Sleeves with safety key		90/60x100x50	

Spare parts

8	L	5115		Turnblade spurs VS 2		TC:19x2	
2	L	8298		Corner knives		KM23/1, N7	
2	L	415048		ProfilCut Q knife		MC:20.1x21x2.4,PT9.4	
2	L	601628		Turnblade knives WPB/8B-MC		MC:7.7x8x1.5;:50°	
2	L	601633		Turnblade knives WBB/25B-MC		MC:25x8x1.5;:50°	



2022	date	name	Variable attributes
prov.	29.03.	REH	BFT = B BO = 50.000 BZH = 0.000 KLH = 100.00 NH = 5.00 PBZ = 92777
exam.			
del.			

Turnblade toolset FZ
MC:RE,Z2,d50,3-TLG,92777

50761 Leitz Tooling UK Ltd
Order: K 25 22 35472 1-51 / Pos. 6
Id.no.: L 954007 / 711003
Art.no.: SW 250 1

P	St	IdNo.	Article No.	Title	BK	Dimension	Comment
1	L	28635	TR 100 0	Spacer		90x4x60,6NL_DTK75	
2	L	160005921	TR 100 0	Spacer		90x9x60,3NL_DTK75	
3	L	160005823	TR 100 0	Spacer		90x30x60,3NL_DTK75	
4	L	414986	WE 840 1 53	ProfilCut Q cutterhead		MC:284x10x60_Z2,V2	
5	L	160005972	TR 100 0	Spacer		90x7,9x60,3NL_DTK75	
6	L	28020	TR 100 0	Spacers		90x0.1x60,6NL_DTK75	
7	L	415000	WW 800 1	Turnblade slotting disc		MC:284x10x60_Z3V4	
8	L	28634	TR 100 0	Spacer		90x3x60,6NL_DTK75	
9	L	28637	TR 100 0	Spacer		90x10x60,6NL_DTK75	
10	L	29679	TB 260 0	Sleeves with safety key		90/60x100x50	

Spare parts

6	L	5115		Turnblade spurs VS 2		TC:19x2	
2	L	414987		ProfilCut Q knife		MC:9.8x15.8x2.4,PT6.1	
2	L	601629		Turnblade knives WPB/10B-MC		MC:9.7x8x1.5,;50°	



2022	date	name	Variable attributes
prov.	29.03.	REH	BFT = B BO = 50.000 BZH = 0.000 KLH = 100.00 NH = 5.00 PBZ = 92777
exam.			
det.			

ProfilCut Q tool-set
MC: RE,Z2,d50,2-TLG.,92777

50761 Leitz Tooling UK Ltd
Order: K 25 22 35472 1-51 / Pos. 7

Id.no.: L 954008 / 711003
At.no.: SE 251 1 53

page

6(31)

P	St	IdNo.	Article No.	Title	BK	Dimension	Comment
1	L	160006330	TR 100 0	Spacer		90x25x60,6NL,DTK75	
2	L	415049	WE 500 1 53	ProfilCut Q cutterhead		MC:164x19.89/21x60,Z2	
3	L	414989	WE 500 1 53	ProfilCut Q cutterhead		MC:185x52.84x60,Z2/2,V2	
4	L	11002142	700338 TB 260 0	Sleeve w. fl.,end r.& anti tw.		90/60x100x31.75	

Spare parts

2	L	5115		Turnblade spurs VS 2		TC:19x2	
2	L	8298		Corner knives		KM23/1, N7	
2	L	414990		ProfilCut Q knife		MC:25.1x15.8x2.4,PT6	
2	L	415050		ProfilCut Q knife		MC:20.2x21.8x2.4,PT12	
2	L	601634		Turnblade knives WPB/30B-MC		MC:30x8x1.5,;50°	



2022	date	name	Variable attributes
prov.	29.03.	REH	BFT = B BO = 31.750 BZH = 0.000 KLH = 100.00 NH = 5.00 PBZ = 92777
exam.			
del.			

ProfilCut Q tool-set
MC:RE.Z2,d31.75.2-TLG.-92777

50761 Leitz Tooling UK Ltd
Order: K 25 22 35472 1-51 / Pos. 42
Id.no.: L 954009 / 711001
Art.no.: SE 200 1 53

P	St	IdNo.	Article No.	Title	BK	Dimension	Comment
1	L	160005817	TR 100 0	Spacer		90x18x60,3NL,DTK75	
2	L	414991	WE 500 1 53	ProfilCut Q cutterhead		MC:146x19.89/22.9x60,ZZ	
3	L	28636	TR 100 0	Spacer		90x5x60,6NL,DTK75	
4	L	414905	WE 500 1 53	ProfilCut Q cutterhead		MC:175x40.6x60,ZZ/2/2	
5	L	414903	WE 500 1 53	ProfilCut Q cutterhead		MC:166x19.89/20.1x60,ZZ	
6	L	11002142	700338 TB 260 0	Sleeve w. fl.,end r.& amid tw.		90/60x100x31.75	

Spare parts

2	L	8293		Corner knives		KM22/0, R3	
2	L	414904		ProfilCut Q knife		MC:20.2x14x2.4,PT3.3	
2	L	414906		ProfilCut Q knife		MC:20.2x21.5x2.4,PT9.3	
2	L	414907		ProfilCut Q knife		MC:20.1x15.8x2.4,PT5.4	
2	L	414908		ProfilCut Q knife		MC:20.1x13.97x2.4,PT5	
2	L	414910		ProfilCut Q knife		MC:20.2x14x2.4,PT3.1	



2022	date	name	Variable attributes
prov.	29.03.	REH	BFT = B BO = 31.750 BZH = 0.000 KLH = 100.00 NH = 5.00 PBZ = 92777
exam.			
det.			

ProfilCut Q tool-set
MC:RE.ZZ,d31.75,3-TLG.,92777

50761 Leitz Tooling UK Ltd
Order: K 25 22 35472 1-51 / Pos. 43
Id.no.: L 954010 / 711001
Art.no.: SE 220 1 53

P	St	IdNo.	Article No.	Title	BK	Dimension	Comment
1	L	28635	TR 100 0	Spacer		90x4x60,6NL_DTK75	
2	L	160005808	TR 100 0	spacers		90x14x60,6NL_DTK75	
3	L	414997	WW 210 1	Turnblade jointing cutterhead		MC:140x19.63/22x60,Z2	
4	L	28636	TR 100 0	Spacer		90x5x60,6NL_DTK75	
5	L	414996	WE 500 1 53	ProfilCut Q cutterhead		MC:181x40.8x60,Z2/2/2	
6	L	414995	WE 500 1 53	ProfilCut Q cutterhead		MC:171.75x19.89/20.1x60,Z2	
7	L	11002142	700338 TB 260 0	Sleeve w. fl.,end r.& anti tw.		90/60x100x31,75	

Spare parts

2	L	8293		Corner knives		KM220, R3	
2	L	414904		ProfilCut Q knife		MC:20.2x14x2.4,PT3.3	
2	L	414906		ProfilCut Q knife		MC:20.2x21.5x2.4,PT9.3	
2	L	414907		ProfilCut Q knife		MC:20.1x15.8x2.4,PT3.4	
2	L	414908		ProfilCut Q knife		MC:20.1x13.97x2.4,PT5	
2	L	601632		Turnblade knives WP8/20B-MC		MC:19.7x8x1.5,;50"	

	2022	date	name	Variable attributes	
	prov.	29.03.	REH	BFT = B	50761 Leitz Tooling UK Ltd
	exam.			BO = 31.750	Order: K 25 22 35472 1-51 / Pos. 44
	det.			BZH = 0.000	Id.no.: L 954011 / 711001
				KJH = 100.00	page
				NH = 5.00	25(31)
				PRZ = 92777	Art.no.: SE 220 1 53
				ProfilCut Q tool-set	
				MC:RE.Z2,d31.75,3-TLG.,92777	

P	St	IdNo.	Article No.	Title	BK	Dimension	Comment
1	L	28635	TR 100 0	Spacer		90x4x60,6NL_DTK75	
2	L	160005808	TR 100 0	spacers		90x14x60,6NL_DTK75	
3	L	414994	WE 500 1 53	ProfilCut Q cutterhead		MC:147x19.89/22.6x60,Z2	
4	L	28635	TR 100 0	Spacer		90x4x60,6NL_DTK75	
5	L	162020311	TR 100 0	Spacer		90x40x60,3NL_DTK75	
6	L	11002142	700338 TB 260 0	Sleeve w. fl.,end r.& anti tw.		90/60x100x31,75	

Spare parts

2	L	8206		Corner knives		KM22/5, R3F	
2	L	414911		ProfilCut Q knife		MC:20.2x15x2.4,PT4.8	



2022	date	name	Variable attributes
prov.	29.03.	REH	BFT = B BO = 31.750 BZH = 0.000 KLH = 100.00 NH = 5.00 PBZ = 92777
exam.			
del.			

ProfilCut Q tool-set MC:RE.Z2,d31.75,1-TLG.,92777	
--	--

50761 Leitz Tooling UK Ltd Order: K 25 22 35472 1-51 / Pos. 45	page 26(31)
Id.no.: L 954012 / 711001 At.no.: SE 220 1 53	

P	St	IdNo.	Article No.	Title	BK	Dimension	Comment
1	L	28635	TR 100 0	Spacer		90x4x60,6NL_DTK75	
2	L	28023	TR 100 0	Spacers		90x1x60,6NL_DTK75	
3	L	28638	TR 100 0	Spacer		90x20x60,6NL_DTK75	
4	L	415004	WE 500 1 53	ProfilCut Q cutterhead		MC:158x19.89x60,ZZ	
5	L	28637	TR 100 0	Spacer		90x10x60,6NL_DTK75	
6	L	415138	WW 200 1	Turnblade jointing cutterhead		MC:140x49.93x60,ZZ	
7	L	415007	WE 500 1 53	ProfilCut Q cutterhead		MC:158x19.89x60,ZZ	
8	L	11004683	770041 TB 260 0	Sleeve w. fl.,end r.& anti tw.		90/60x100x31.75	

Spare parts

2	L	415005		ProfilCut Q knife		MC:20.2x19.5x2.4,PT9.6	
2	L	415008		ProfilCut Q knife		MC:20.2x19.5x2.4,PT9.6	
2	L	601638		Turnblade knives WPB/50B-MC		MC:50x8x1.5,;50°	
2	L	168288826		Grooving knife		HW:36x20x2.7/4.2	
2	L	168288827		Grooving knife		HW:36x20x2.7/4.2	



2022		Variable attributes	
prov.	29.03.	name	BFT = B
exam.		REH	BO = 31.750
det.			SOH = 0.000
			KLH = 100.00
			NH = 5.00
			PGZ = 02778

ProfilCut Q tool-set
 MC:RE,ZZ,d31.75,3-TLG-,92778

50761 Leitz Tooling UK Ltd
 Order: K 25 22 35472 1-51 / Pos. 46
 Id.no.: L 954013 / 711001
 A1.no.: SE 200 1 53

P	St	IdNo.	Article No.	Title	BK	Dimension	Comment
1	L	160006330	TR 100 0	Spacer		90x25x60,6NL_DTK75	
2	L	28638	TR 100 0	Spacer		90x20x60,6NL_DTK75	
3	L	260001020	700036 AT 100 0	Zw.-Ringsatz 6NL DTK75		90x6x60,6_DTK75	
4	L	415142	WE 500 1 53	ProfilCut Q cutterhead		MC:162.5x15x60_Z2	
5	L	28636	TR 100 0	Spacer		90x5x60,6NL_DTK75	
6	L	160005926	TR 100 0	Spacer		90x8x60,3NL_DTK75	
7	L	11002142	700338 TB 260 0	Sleeve w. fl.,end r.& anti tw.		90/60x100x31.75	

Spare parts

2 L 415143 ProfilCut Q knife MC:15x20x2.4,PT9



2022		Variable attributes	
prov.	29.03.	name	BFT = B
exam.		REH	BO = 31.750
del.			BLZH = 0.000
			KLH = 100.00
			NH = 5.00
			PROZ = 92778

ProfilCut Q tool-set
MC:RE,Z2,d31.75,1-TLG,92778

50761 Leitz Tooling UK Ltd
Order: K 25 22 35472 1-51 / Pos. 47
Id.no.: L 954014 / 711001
Art.no.: SE 220 1 53

P	St	IdNo.	Article No.	Title	BK	Dimension	Comment
1	2	L 28023	TR 100 0	Spacers		90x1x60,6NL,DTK75	
2	1	L 160005811	TR 100 0	Spacer		90x15x60,6NL,DTK75	
3	1	L 160005801	TR 100 0	Spacer		90x7x60,3NL,DTK75	
4	1	L 170179693	WE 500 1 53	ProfilCut Q cutterhead		MC:145.66x29.74/30.1x60,ZZ	
5	1	L 415139	WE 500 1 53	ProfilCut Q cutterhead		MC:179x39.07x60,ZZ/2	
6	1	L 415141	WW 430 1	Wende Falzwerkzeug		MC:202.8x14.9/19.4x60,ZZ,VZ	
7	1	L 11002142	700338 TB 260 0	Sleeve w. fl.,end r.& anti tw.		90/60x100x31.75	

Spare parts

2	L	5115		Turnblade spurs VS 2		TC:19x2	
2	L	8295		Corner knives		KMZZ/4, R1.5	
2	L	415013		ProfilCut Q knife		MC:20.1x14.39x2.4,PT5.4	
2	L	415015		ProfilCut Q knife		MC:30.2x14.5x2.4,PT2.5	
2	L	415140		ProfilCut Q knife		MC:35.1x15.0x2.4,PT6.6	
2	L	601631		Turnblade knives WPB/15B-MC		MC:14.7x8x1.5;:50°	
4	L	168288326		Grooving knife		HW:36x20x2.7/4.2	



Variable attributes

2022	date	name
prov.	29.03.	REH
exam.		
del.		

ProfilCut Q tool-set
MC:RE,ZZ,d31.75,3-TLG.

50761 Leitz Tooling UK Ltd
Order: K 25 22 35472 1-51 / Pos. 14
Id.no.: L 170179576
Art.no.: SE 221 2 53

page

7(31)

P	St	IdNo.	Article No.	Title	BK	Dimension	Comment
1	L	160006330	TR 100 0	Spacer		90x25x60,6NL_DTK75	
2	L	28638	TR 100 0	Spacer		90x20x60,6NL_DTK75	
3	L	415144	WE 500 1 53	ProfilCut Q cutterhead		MC:159x69.11x60_Z2/2	
4	L	11002142	700338 TB 260 0	Sleeve w. fl.,end r.& and tw.		90/60x100x31.75	

Spare parts

2	L	8293		Corner knives		KM220, R3	
2	L	415145		ProfilCut Q knife		MC:25.2x19.5x2.4,PT10.2	
2	L	601638		Turnblade knives WP8/50B-MC		MC:50x8x1.5.;50°	



Variable attributes

2022	date	name	value
prov.	29.03.	REH	BFT = B
exam.			BO = 31.750
det.			BZH = 0.000
			KLH = 100.00
			NH = 5.00
			PEZ = 92778

ProfilCut Q tool-set
MC:RE_Z2,d31.75,1-TLG_92778

Id.no.: L 954016 / 711001
Art.no.: SE 220 1 53

page

1(1)

P	St	IdNo.	Article No.	Title	BK	Dimension	Comment
1	L	160005813	TR 100 0	Spacer		90x16x60,3NL_DTK75	
2	L	28635	TR 100 0	Spacer		90x4x60,6NL_DTK75	
3	L	415146	WE 500 1 53	ProfilCut Q cutterhead		MC:100x42.26/46.6x60,Z2/2	
4	L	415037	WE 500 1 53	ProfilCut Q cutterhead		MC:174x29.74x60,Z2	
5	L	11002142	700338 TB 260 0	Sleeve w. fl. and r. & anti tw.		90/60x100x31.75	

Spare parts

2	L	8293		Corner knives		KM22/0, R3	
2	L	8323		Turnblade-grooving-knife NB4		TC:36x20x4	
2	L	415036		ProfilCut Q knife		MC:25.2x20.5x2.4,PT11	
2	L	415038		ProfilCut Q knife		MC:30.2x26x2.4,PT16.8	
2	L	601632		Turnblade knives WPR/20B-MC		MC:19.7x8x1.5,;50°	

leitz

2022	prov.	exam.	dest.	date	name	Variable attributes
	29.03.			29.03.	REH	BFT = B BO = 31.750 RZH = 0.000 KLH = 100.00 NH = 5.00 PBZ = 92778

ProfilCut Q tool-set
MC:RE,ZZ,d31.75,2-TLG-,92778

Id.No.: L 954018 / 711001
Art.No.: SE 220 1 53

page
1(1)

P	St	IdNo.	Article No.	Title	BK	Dimension	Comment
1	L	28038	TR 100 0	Spacer		90x20x60,6NL,DTK75	
2	L	28035	TR 100 0	Spacer		90x4x60,6NL,DTK75	
3	L	415147	WE 500 1 53	ProfilCut Q cutterhead		MC:193.4x41.9/42.6x60,Z2/2	
4	L	415041	WE 500 1 53	ProfilCut Q cutterhead		MC:162.4x32.7x60,Z2/2	
5	L	11002142	700338 TB 260 0	Sleeve w. fl.,end r.& anti tw.		90/60x100x31.75	

Spare parts

2	L	8293		Corner knives		KM220, R3	
2	L	8322		Turnblade-grooving-knife NB3S		TC:36x20x3	
2	L	415040		ProfilCut Q knife		MC:25.2x26.5x2.4,PT16.9	
2	L	415043		ProfilCut Q knife		MC:20.2x21.5x2.4,PT12.1	
2	L	415044		ProfilCut Q knife		MC:20.2x14x2.4,PT3.1	
2	L	601632		Turnblade knives WPB/20B-MC		MC:19.7x8x1.5;50°	



2022	date	name	Variable attributes
prov.	29.03.	REH	BET = B BO = 31.750 BZH = 0.000 KLH = 100.00 NH = 5.00 PBZ = 92778
exam.			
det.			

ProfilCut Q tool-set
MC:RE.ZZ,d31.75,2-TLG,92778

P	St	IdNo.	Article No.	Title	BK	Dimension	Comment
1	L	160006330	TR 100 0	Spacer		90x25x60,GNL_DTK75	
2	L	170179681	WE 500 1 53	ProfilCut Q cutterhead		MC:150x19,89/20,1x60,ZZ	
3	L	170179678	WE 500 1 53	ProfilCut Q cutterhead		MC:195,8x41x60,ZZ/2/2	
4	L	170179677	WE 500 1 53	ProfilCut Q cutterhead		MC:186,79x19,89/20,1x60,ZZ	
5	L	11002142	700338 TB 260 0	Sleeve w. fl_end r.& anti tw.		90/60x100x31,75	

Spare parts

2	L	8321		Turnblade-grooving-knife NB3B		TC:36x20x3	
2	L	414904		ProfilCut Q knife		MC:20,2x14x2,4,PT3,3	
2	L	601032		Turnblade knives WPB/20B-MC		MC:19,7x8x1,5,;50°	
2	L	170179679		ProfilCut Q knife		MC:20,2x21x2,4,PT9,2	
2	L	170179680		ProfilCut Q knife		MC:25,1x14,83x2,4,PT5,8	
2	L	170179682		ProfilCut Q knife		MC:20,2x15,5x2,4,PT4,9	



Variable attributes

2022	date	name
prev.	29.03.	REH
exam.		
del.		

ProfilCut Q tool-set
MC:RE,ZZ,d31,75,3-TLG.

50761 Leitz Tooling UK Ltd
Order: K 25 22 35472 1-51 / Pos. 22
Id.no.: L 170179671
Art.no.: SE 220 1 53

P	St	IdNo.	Article No.	Title	BK	Dimension	Comment
---	----	-------	-------------	-------	----	-----------	---------

1	L	170179685	WW 850 1	Turnblade tenoning disc		MC:238x14.59x60,Z2	
2	L	170179683	WE 840 1 53	ProfilCut Q cutterhead		MC:320.2x13x60,Z2,V4	
3	L	160005940	TR 100 0	Spacer		90x11x00,3NL,OTK75	

Spare parts

4	L	5115		Turnblade spurs VS 2		TC:19x2	
2	L	601631		Turnblade knives WP8/15B-MC		MC:14.7x8x1.5;50°	
2	L	170179684		ProfilCut Q knife		MC:12.8x21.5x2.4,PT11.2	



2022	date	name
prov.	29.03.	REH
exam.		
def.		

Variable attributes

50761 Leitz Tooling UK Ltd	
Order: K 25 22 35472 1-51 / Pos. 24	
Id.no.: L 170179672	page
Art.no.: SE 250 1 53	14(31)

ProfilCut Q tool-set
MC:RE,Z2,d60,2-TLG.

P	St	IdNo.	Article No.	Title	BK	Dimension	Comment
---	----	-------	-------------	-------	----	-----------	---------

90x15x60,6NL_DTK75
MC:185x30.29/31.5x60_Z2/2,VZ

Spacer
ProfilCut Q cutterhead

1 1 L 160005811 TR 100 0
2 1 L 170179686 WE 500 1 53

Spare parts

2 L 5115	Turnblade spurs VS 2	TC:19x2
2 L 170179687	ProfilCut Q knife	MC:20.2x14x2.4,PT3.1
2 L 170179688	ProfilCut Q knife	MC:15.1x14x2.4,PT3.1
2 L 170179694	Grooving knife	HW:36x20x2.7/4.2



Variable attributions

2022	date	name
prov.	29.03.	REH
exam.		
del.		

ProfilCut Q tool-set
MC:RE_Z2,d60,1-TLG.

50761 Leitz Tooling UK Ltd
Order: K 25 22 35472 1-51 / Pos. 25
Id.no.: L 170179673
Art.no.: SE 200 1 53

page

15(31)

))

))

))

))

P	St	IdNo.	Article No.	Title	BK	Dimension	Comment
1	L	160005801	TR 100 0	Spacer		90x7x60,3NL_DTK75	
2	L	160005823	TR 100 0	Spacer		90x30x60,3NL_DTK75	
3	L	170179689	WE 500 1 53	ProfilCut Q cutterhead		MC:170x54.2x60,Z2/2	
4	L	11002142	700338 TB 260 0	Sleeve w. fl.,end r.& anti tw.		90/60x100x31.75	

Spare parts

2	L	170179690		ProfilCut Q knife		MC:30.2x21.8x2.4,PT12	
2	L	170179691		ProfilCut Q knife		MC:30.2x25x2.4,PT14.6	



2022	date	name	Variable attributes
prov.	29.03.	REH	
exam.			
del.			

ProfilCut Q tool-set	
MC:RE,170,d31.75,Z2,1-TLG.	

50761 Leitz Tooling UK Ltd	
Order: K 25 22 35472 1-51 / Pos. 26	
Id.no.: L 170179674	page
Art.no.: SE 540 1 53	16(31)